

# AUTOMOTIVE FASTENERS SERIES

## Q653 Flared Couplings - Union Elbow

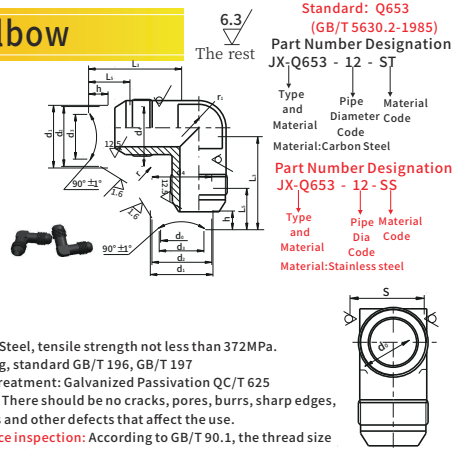

**Standard:** Q653 (GB/T 5630.2-1985)  
**Part Number Designation:** JX-Q653 - 12 - ST  
 Type and Material: Carbon Steel  
**Part Number Designation:** JX-Q653 - 12 - SS  
 Type and Material: Stainless steel

**Material:** Steel, tensile strength not less than 372MPa.  
**Thread:** 6g, standard GB/T 196, GB/T 197  
**Surface Treatment:** Galvanized Passivation QC/T 625  
**Remarks:** There should be no cracks, pores, burrs, sharp edges, rust spots and other defects that affect the use.  
**Acceptance inspection:** According to GB/T 90.1, the thread size AQL=1.5, the flare end size AQL=1.5, and the other sizes AQL=4.0. When there are special requirements, both parties shall negotiate.

Unit:mm

| Pipe DIA<br>D <sub>0</sub> | P/N           |                 | Thread Size<br>d <sub>1</sub> | d <sub>0</sub> | d <sub>2</sub> | d <sub>3</sub> | d <sub>4</sub> | L <sub>3</sub> | L <sub>5</sub> | h   | r <sub>1</sub> | r | S  |
|----------------------------|---------------|-----------------|-------------------------------|----------------|----------------|----------------|----------------|----------------|----------------|-----|----------------|---|----|
|                            | Carbon Steel  | Stainless steel |                               |                |                |                |                |                |                |     |                |   |    |
| 5                          | JX-Q653-5-ST  | JX-Q653-5-SS    | M10X1                         | 3.5            | 8.4            | 4.3            | 8              | 20.5           | 9.5            | 4.5 | 4              |   | 8  |
| 6                          | JX-Q653-6-ST  | JX-Q653-6-SS    | M12X1.5                       | 4              | 10             | 4.8            | 10             | 24             | 12             | 5   | 5              |   | 10 |
| 8                          | JX-Q653-8-ST  | JX-Q653-8-SS    | M14X1.5                       | 6              | 11.7           | 7              | 11             | 28.5           | 13.5           | 5.5 | 5.5            | 2 | 11 |
| 10                         | JX-Q653-10-ST | JX-Q653-10-SS   | M16X1.5                       | 8              | 13.7           | 9              | 13             | 30.5           |                | 6   | 6.5            |   | 13 |
| 12                         | JX-Q653-12-ST | JX-Q653-12-SS   | M18X1.5                       | 10             | 15.7           | 11             | 15             | 31.5           | 1.45           | 6   | 7.5            |   | 16 |

## Q654 Flared Couplings - Male Elbow - Body

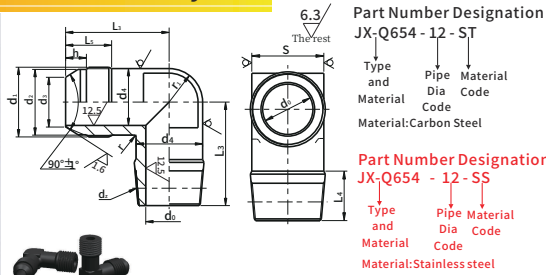

**Standard:** Q654 (QC/T 404-1999)  
**Part Number Designation:** JX-Q654 - 12 - ST  
 Type and Material: Carbon Steel  
**Part Number Designation:** JX-Q654 - 12 - SS  
 Type and Material: Stainless steel

**Material:** Steel, tensile strength not less than 372MPa.  
**Thread:** 6g, standard GB/T 196, GB/T 197  
**Surface Treatment:** Galvanized Passivation QC/T 625  
**Remarks:** There should be no cracks, pores, burrs, sharp edges, rust spots and other defects that affect the use.  
**Acceptance inspection:** According to GB/T 90.1, the thread size AQL=1.5, the flare end size AQL=1.5, and the other sizes AQL=4.0. When there are special requirements, both parties shall negotiate.

Unit:mm

| Pipe Diameter<br>D <sub>0</sub> | P/N          |                 | Thread Size    |                | d <sub>0</sub> | d <sub>2</sub> | d <sub>3</sub> | d <sub>4</sub> | L <sub>4</sub> | L <sub>3</sub> | L <sub>5</sub> | h   | r <sub>1</sub> | r | S  |
|---------------------------------|--------------|-----------------|----------------|----------------|----------------|----------------|----------------|----------------|----------------|----------------|----------------|-----|----------------|---|----|
|                                 | Carbon Steel | Stainless steel | d <sub>2</sub> | d <sub>1</sub> |                |                |                |                |                |                |                |     |                |   |    |
| 5                               | JX-Q654-5    | JX-Q654S-5      | NPT1/8         | M10X1          | 3.5            | 8.4            | 4.3            | 8              | 10             | 20.5           | 9.5            | 4.5 | 4              |   | 8  |
| 6                               | JX-Q654-6    | JX-Q654S-6      | NPT1/8         | M12X1.5        | 4              | 10             | 4.8            | 10             |                | 24             | 12             | 5   | 5              |   | 10 |
| 8                               | JX-Q654-8    | JX-Q654S-8      | NPT1/4         | M14X1.5        | 6              | 11.7           | 7              | 11             |                | 28.5           | 13.5           | 5.5 | 5.5            | 2 | 11 |
| 10                              | JX-Q654-10   | JX-Q654S-10     | NPT1/4         | M16X1.5        | 8              | 13.7           | 9              | 13             |                | 30.5           |                | 6   | 6.5            |   | 13 |
| 12                              | JX-Q654-12   | JX-Q654S-12     | NPT3/8         | M18X1.5        | 10             | 15.7           | 11             | 15             |                | 31.5           | 1.45           | 6   | 7.5            |   | 16 |

# AUTOMOTIVE FASTENERS SERIES

## Q655B Flared Couplings - Union

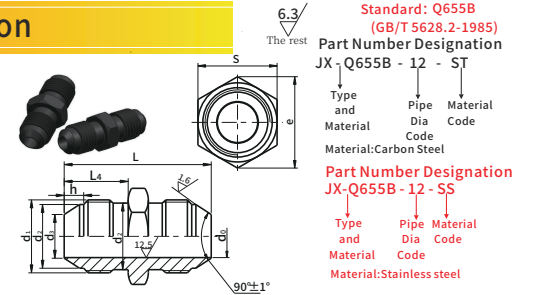

**Standard:** Q655B (GB/T 5628.2-1985)  
**Part Number Designation:** JX-Q655B - 12 - ST  
 Type and Material: Carbon Steel  
**Part Number Designation:** JX-Q655B - 12 - SS  
 Type and Material: Stainless steel

**Material:** Steel, tensile strength not less than 372MPa.  
**Thread:** 6g, standard GB/T 196, GB/T 197  
**Surface Treatment:** Galvanized Passivation QC/T 625  
**Remarks:** There should be no cracks, pores, burrs, sharp edges, rust spots and other defects that affect the use.  
**Acceptance inspection:** According to GB/T 90.1, the thread size AQL=1.5, the flare end size AQL=1.5, and the other sizes AQL=4.0. When there are special requirements, both parties shall negotiate.

Unit:mm

| Pipe Diameter<br>D <sub>0</sub> | P/N         |                 | Thread Size<br>d <sub>1</sub> | d <sub>0</sub> | d <sub>2</sub> | d <sub>3</sub> | L <sub>4</sub> | h   | L    | e    | s  |    |
|---------------------------------|-------------|-----------------|-------------------------------|----------------|----------------|----------------|----------------|-----|------|------|----|----|
|                                 | Steel       | Stainless steel |                               |                |                |                |                |     |      |      |    |    |
| 5                               | JX-Q655B-5  | JX-Q655BS-5     | M10X1                         | 3.5            | 8.4            | 4.3            | 12.5           | 4.5 | 30   |      | 15 | 13 |
| 6                               | JX-Q655B-6  | JX-Q655BS-6     | M12X1.5                       | 4              | 10             | 4.8            | 15.7           |     | 36.4 |      |    |    |
| 8                               | JX-Q655B-8  | JX-Q655BS-8     | M14X1.5                       | 6              | 11.7           | 7              | 18             | 5.5 | 42   | 18.5 | 16 |    |
| 10                              | JX-Q655B-10 | JX-Q655BS-10    | M16X1.5                       | 8              | 13.7           | 9              |                |     | 44   | 20.8 | 18 |    |
| 12                              | JX-Q655B-12 | JX-Q655BS-12    | M18X1.5                       | 10             | 15.7           | 11             | 19             | 6   | 45   | 24.2 | 21 |    |

## Q656 Flared Couplings - Male Branch Tee - Body

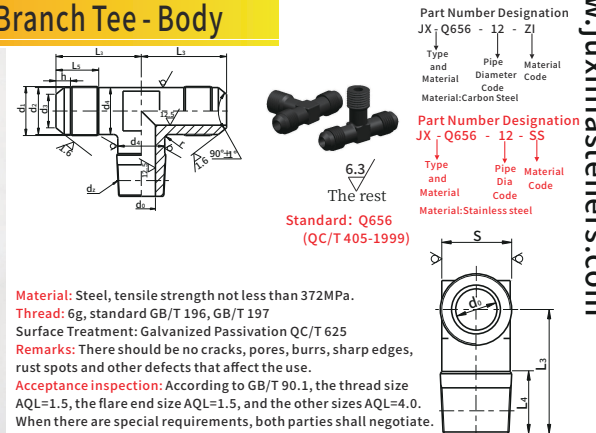

**Standard:** Q656 (QC/T 405-1999)  
**Part Number Designation:** JX-Q656 - 12 - ZI  
 Type and Material: Carbon Steel  
**Part Number Designation:** JX-Q656 - 12 - SS  
 Type and Material: Stainless steel

**Material:** Steel, tensile strength not less than 372MPa.  
**Thread:** 6g, standard GB/T 196, GB/T 197  
**Surface Treatment:** Galvanized Passivation QC/T 625  
**Remarks:** There should be no cracks, pores, burrs, sharp edges, rust spots and other defects that affect the use.  
**Acceptance inspection:** According to GB/T 90.1, the thread size AQL=1.5, the flare end size AQL=1.5, and the other sizes AQL=4.0. When there are special requirements, both parties shall negotiate.

Unit:mm

| Pipe Diameter<br>D <sub>0</sub> | P/N        |                 | Thread Size    |                | d <sub>0</sub> | d <sub>2</sub> | d <sub>3</sub> | d <sub>4</sub> | L <sub>4</sub> | L <sub>3</sub> | L <sub>5</sub> | h   | r <sub>1</sub> | r | S  |
|---------------------------------|------------|-----------------|----------------|----------------|----------------|----------------|----------------|----------------|----------------|----------------|----------------|-----|----------------|---|----|
|                                 | Steel      | Stainless steel | d <sub>2</sub> | d <sub>1</sub> |                |                |                |                |                |                |                |     |                |   |    |
| 5                               | JX-Q656-5  | JX-Q656S-5      | NPT1/8         | M10X1          | 3.5            | 8.4            | 4.3            | 8              | 10             | 20.5           | 9.5            | 4.5 | 4              |   | 8  |
| 6                               | JX-Q656-6  | JX-Q656S-6      | NPT1/8         | M12X1.5        | 4              | 10             | 4.8            | 10             |                | 24             | 12             |     | 5              |   | 10 |
| 8                               | JX-Q656-8  | JX-Q656S-8      | NPT1/4         | M14X1.5        | 6              | 11.7           | 7              | 11             |                | 28.5           | 13.5           | 5.5 | 5.5            | 2 | 11 |
| 10                              | JX-Q656-10 | JX-Q656S-10     | NPT1/4         | M16X1.5        | 8              | 13.7           | 9              | 13             |                | 30.5           |                | 6   | 6.5            |   | 13 |
| 12                              | JX-Q656-12 | JX-Q656S-12     | NPT3/8         | M18X1.5        | 10             | 15.7           | 11             | 15             |                | 31.5           | 1.45           | 6   | 7.5            |   | 16 |