

JX AUTOMOTIVE FASTENERS SERIES

Q810 24° Cone Connectors - Male Branch Tee - Body

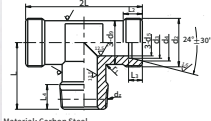

Material: Carbon Steel
 Thread: d-GB/T 12176, d0-tolerance 6g, according to GB/T 196, GB/T 197
 Surface treatment: zinc passivation, standard QC/T 625
 Product defects: There should be no cracks, pores, burrs, sharp edges, rust spots and other defects that affect the use.
 Acceptance and packaging: according to GB/T 90.1, GB/T 90.2, where thread AQL=1.5, ferrule end size AQL=1.5, and other sizes AQL=4.0. When there are special requirements, it shall be negotiated by both parties.

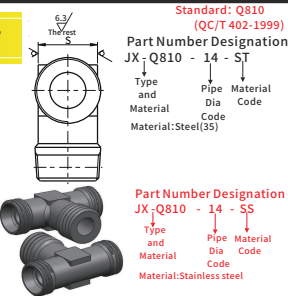

Unit:mm

Nominal pressure (Mpa)	Pipe Diameter (D ₀)	P/N		d ₃		d ₂	d ₅	L ₄	L	d ₂	d ₄ +0.10 -0	d ₉	L ₂	L ₃ +0.3 -0	L ₁	r ₁	S
		Steel	Stainless steel	Nominal size	Limit deviation												
E (16)	4	JX-Q810-4-ST	JX-Q810-4-SS	4		NPT 1/8	3	10	20	M10X1	6.1	8	5.5	6.5	18.5	2	8
	5	JX-Q810-5-ST	JX-Q810-5-SS	5			3.5			7.1	7	20	10				
	6	JX-Q810-6-ST	JX-Q810-6-SS	6			4			8.1	10	7	20	11			
	8	JX-Q810-8-ST	JX-Q810-8-SS	8			6			10.1	11	8.5	24.5	15			
	10	JX-Q810-10-ST	JX-Q810-10-SS	10		NPT 1/4	8	29	M16X1.5	12.3	13		26	15			
	12	JX-Q810-12-ST	JX-Q810-12-SS	12			10	31	M18X1.5	14.3	15	27.5	18				
	14	JX-Q810-14-ST	JX-Q810-14-SS	14		NPT 3/8	12	32	M20X1.5	16.3	17	9	7.5	28.5	21		
	16	JX-Q810-16-ST	JX-Q810-16-SS	16			14	36	M22X1.5	18.3	19	30.5	24				
	18	JX-Q810-18-ST	JX-Q810-18-SS	18		NPT 1/2	15	38	M24X1.5	20.3	21		8.5	34	27		
	20	JX-Q810-20-ST	JX-Q810-20-SS	20			17	41	M27X1.5	22.7	24	38	30				
	22	JX-Q810-22-ST	JX-Q810-22-SS	22		NPT 3/4	19	43	M30X2	24.7	26	12	9.5	40.5	34		
	25	JX-Q810-25-ST	JX-Q810-25-SS	25			22	48	M33X2	27.7	30	40.5	34				
	28	JX-Q810-28-ST	JX-Q810-28-SS	28		NPT 1	24	48	M36X2	30.7	32			41			
	32	JX-Q810-32-ST	JX-Q810-32-SS	32			27	55	M42X2	35	38	13	10.5	46.5			

Q811 24° Cone Connectors - Male Run Tee - Body

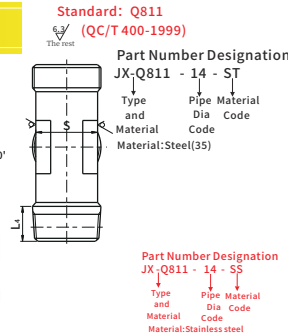
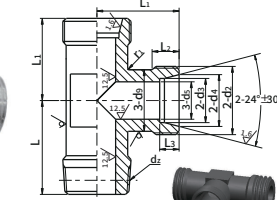
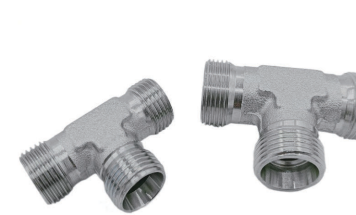

Unit:mm

Nominal Pressure (MPa)	Pipe Diameter (D ₀)	P/N		d ₃		d ₂	d ₅	L ₄	L	d ₂	d ₄ +0.10 -0	d ₉	L ₂	L ₃ +0.3 -0	r ₁	S	L ₁
		Steel	Stainless steel	Nominal size	Limit deviation												
E (16)	4	JX-Q811-4-ST	JX-Q811-4-SS	4		NPT 1/8	3	10	20	M10X1	6.1	8	5.5	6.5	2	8	18.5
	5	JX-Q811-5-ST	JX-Q811-5-SS	5			3.5			7.1	7	20	10	20			
	6	JX-Q811-6-ST	JX-Q811-6-SS	6			4			8.1	10	7	20	11		24.5	
	8	JX-Q811-8-ST	JX-Q811-8-SS	8			6			10.1	11	8.5	24.5	15		27.5	
	10	JX-Q811-10-ST	JX-Q811-10-SS	10		NPT 1/4	8	29	M16X1.5	12.3	13		26	15			
	12	JX-Q811-12-ST	JX-Q811-12-SS	12			10	31	M18X1.5	14.3	15	27.5	18				
	14	JX-Q811-14-ST	JX-Q811-14-SS	14		NPT 3/8	12	32	M20X1.5	16.3	17	9	7.5	28.5	21		
	16	JX-Q811-16-ST	JX-Q811-16-SS	16			14	36	M22X1.5	18.3	19	30.5	24				
	18	JX-Q811-18-ST	JX-Q811-18-SS	18		NPT 1/2	15	38	M24X1.5	20.3	21		8.5	34	27		
	20	JX-Q811-20-ST	JX-Q811-20-SS	20			17	41	M27X1.5	22.7	24	38	30				
	22	JX-Q811-22-ST	JX-Q811-22-SS	22		NPT 3/4	19	43	M30X2	24.7	26	12	9.5	40.5	34		
	25	JX-Q811-25-ST	JX-Q811-25-SS	25			22	48	M33X2	27.7	30	40.5	34				
	28	JX-Q811-28-ST	JX-Q811-28-SS	28		NPT 1	24	48	M36X2	30.7	32			41			
	32	JX-Q811-32-ST	JX-Q811-32-SS	32			27	55	M42X2	35	38	13	10.5	46.5			

JX AUTOMOTIVE FASTENERS SERIES

Q812 24° Cone Connectors - Union Cross

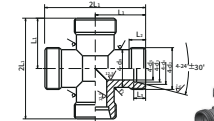
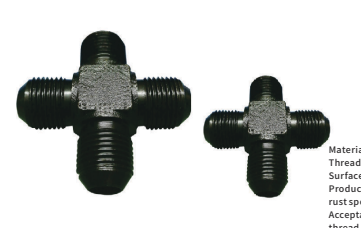

Material: Carbon Steel
 Thread: d-GB/T 12176, d0-tolerance 6g, according to GB/T 196, GB/T 197
 Surface treatment: zinc passivation, standard QC/T 625
 Product defects: There should be no cracks, pores, burrs, sharp edges, rust spots and other defects that affect the use.
 Acceptance and packaging: according to GB/T 90.1, GB/T 90.2, where thread AQL=1.5, ferrule end size AQL=1.5, and other sizes AQL=4.0. When there are special requirements, it shall be negotiated by both parties.

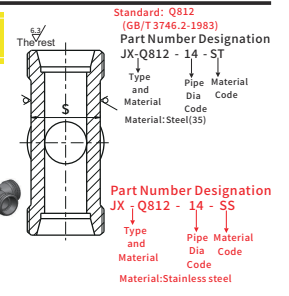

Unit:mm

Nominal pressure (MPa)	Pipe Diameter (D ₀)	P/N		d ₃		d ₄		L ₃		d ₂	d ₅	d ₉	L ₂	L ₁	r ₁	S
		Steel	Stainless steel	Nominal size	Limit deviation	Nominal size	Limit deviation	Nominal size	Limit deviation							
G (25)	4	JX-Q812-4-ST	JX-Q812-4-SS	4		+0.28	6.1	7	6.5	M10X1	3	8	5.5	18.5	2	8
	5	JX-Q812-5-ST	JX-Q812-5-SS	5			7.1				7	10				
	6	JX-Q812-6-ST	JX-Q812-6-SS	6			8.1				10	7	20	11		
	8	JX-Q812-8-ST	JX-Q812-8-SS	8			10.1				11	8.5	24.5	15		
	10	JX-Q812-10-ST	JX-Q812-10-SS	10		+0.21	12.3	7.5	7	M16X1.5	6	8	13	26	2	26
	12	JX-Q812-12-ST	JX-Q812-12-SS	12			14.3			15	8.5	24.5	15			
	14	JX-Q812-14-ST	JX-Q812-14-SS	14		+0.10	16.3	+0.30	+0.30	M18X1.5	10	15		27.5	18	
	16	JX-Q812-16-ST	JX-Q812-16-SS	16			18.3			17	9	28.5	18			
	18	JX-Q812-18-ST	JX-Q812-18-SS	18		+0.40	20.3	8.5	8.5	M20X1.5	12	17		28.5	21	
	20	JX-Q812-20-ST	JX-Q812-20-SS	20			22.7			19	30.5	34	27			
	22	JX-Q812-22-ST	JX-Q812-22-SS	22		+0.30	24.7	9.5	9.5	M22X1.5	14	19	12	38	3	24
	25	JX-Q812-25-ST	JX-Q812-25-SS	25			27.7			20	34	38	27			
	28	JX-Q812-28-ST	JX-Q812-28-SS	28		30.7	30.7	10.5	10.5	M30X2	22	26		40.5	4	34
	32	JX-Q812-32-ST	JX-Q812-32-SS	32			35			32	46.5	41	34			

Q813 24° Cone Connectors - Bulkhead Union

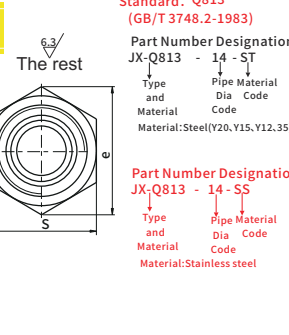
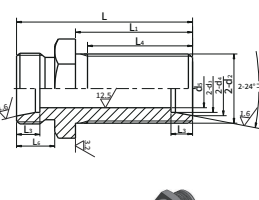
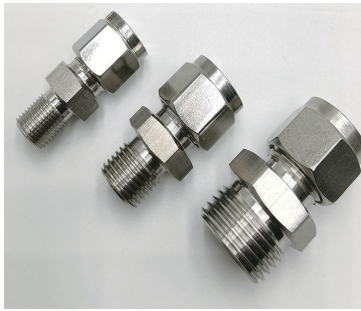

Unit:mm

Nominal pressure (MPa)	Pipe Diameter (D ₀)	P/N		d ₃		d ₄		L ₃		d ₂	d ₅	L ₁	L ₆	L ₄	L	S	e
		Steel	Stainless steel	Nominal size	Limit deviation	Nominal size	Limit deviation	Nominal size	Limit deviation								
G (25)	4	JX-Q813-4-ST	JX-Q813-4-SS	4		+0.28	6.1	7	6.5	M10X1	3	34	8.5	31	47.5	15	17.3
	5	JX-Q813-5-ST	JX-Q813-5-SS	5			7.1				7	10					
	6	JX-Q813-6-ST	JX-Q813-6-SS	6			8.1				10	7	20	11	24.5		
	8	JX-Q813-8-ST	JX-Q813-8-SS	8			10.1				11	8.5	24.5	15	27.5		
	10	JX-Q813-10-ST	JX-Q813-10-SS	10		+0.21	12.3	7.5	7	M16X1.5	6	37	13	32.5	56	18	20.8
	12	JX-Q813-12-ST	JX-Q813-12-SS	12			14.3			15	9	34.5	58.5	21	24.2		
	14	JX-Q813-14-ST	JX-Q813-14-SS	14		+0.10	16.3	+0.30	+0.30	M18X1.5	10	40		35.5	59.5	24	27.7
	16	JX-Q813-16-ST	JX-Q813-16-SS	16			18.3			17	13.5	37.5	63.5	27	31.2		
	18	JX-Q813-18-ST	JX-Q813-18-SS	18		+0.40	20.3	8.5	8.5	M20X1.5	12	42		37.5	63.5	30	34.6
	20	JX-Q813-20-ST	JX-Q813-20-SS	20			22.7			20	39.5	66.5	34	39.3			
	22	JX-Q813-22-ST	JX-Q813-22-SS	22		+0.30	24.7	9.5	9.5	M22X1.5	14	44		40	73	36	41.6
	25	JX-Q813-25-ST	JX-Q813-25-SS	25			27.7			22	40	73	36	41.6			
	28	JX-Q813-28-ST	JX-Q813-28-SS	28		30.7	30.7	10.5	10.5	M30X2	22	48	18	42	77	41	47.3
	32	JX-Q813-32-ST	JX-Q813-32-SS	32			35			32	50	19	44	82	50	57.7	