

AX AUTOMOTIVE FASTENERS SERIES

Non-soldering compression fittings with cutting ring for screwed connections with tapered screw-in spigot form C according to DIN 3852-1 and DIN 3852-2



Material: Carbon Steel
Thread: tolerance 6g, standard GB/T 196, GB/T 197
Remarks: There should be no cracks, pores, burrs, sharp edges, rust spots and other defects that affect the use.
Acceptance and packaging: according to GB/T 90.1, GB/T 90.2, where thread AQL=1.5, ferrule end size AQL=1.5, and other sizes AQL=4.0. When there are special requirements, it shall be negotiated by both parties.

Standard: Q806
(GB/T 3740.2-1983)
Part Number Designation
JX-Q806 - 14 - ST
Type and Material: Steel(35)
Pipe Dia Code
Material Code

Part Number Designation
JX-Q806 - 14 - SS
Type and Material: Stainless steel
Pipe Dia Code
Material Code

Unit:mm

Nominal pressure (MPa)	pipe diameter D ₀	P/N		d ₃		d ₄		L ₃		d ₂	d ₅	d ₉	L ₂	L ₁	r ₂	r ₁	S
		Steel	Stainless steel	Nominal size	Limit deviation	Nominal size	Limit deviation	Nominal size	Limit deviation								
G (25)	4	JX-Q806-4-ST	JX-Q806-4-SS	4		6.1		6.5		M10X1	3	8	5.5	18.5	4		8
	5	JX-Q806-5-ST	JX-Q806-5-SS	5	+0.28	7.1		7		M12X1.25	3.5	10	7	20	5		10
	6	JX-Q806-6-ST	JX-Q806-6-SS	6	+0.21	8.1				M14X1.5	6	11	8.5	24.5	5.5	2	11
	8	JX-Q806-8-ST	JX-Q806-8-SS	8		10.1				M16X1.5	8	13	26	6.5			15
	10	JX-Q806-10-ST	JX-Q806-10-SS	10		12.3				M18X1.5	10	15	27.5	7.5			18
	12	JX-Q806-12-ST	JX-Q806-12-SS	12		14.3		7.5		M20X1.5	12	17	28.5	8.5			21
	14	JX-Q806-14-ST	JX-Q806-14-SS	14		16.3				M22X1.5	14	19	30.5	9.5			24
	16	JX-Q806-16-ST	JX-Q806-16-SS	16	+0.40	18.3	+0.10	8.5		M24X1.5	15	21	34	10.5			27
	18	JX-Q806-18-ST	JX-Q806-18-SS	18	+0.30	20.3	-0			M27X1.5	17	24	38	12	3		30
	20	JX-Q806-20-ST	JX-Q806-20-SS	20		22.7				M30X2	19	26	40.5	13			34
	22	JX-Q806-22-ST	JX-Q806-22-SS	22		24.7				M33X2	22	30	46.5	15	4		38
	25	JX-Q806-25-ST	JX-Q806-25-SS	25		27.7				M36X2	24	32		16			41
28	JX-Q806-28-ST	JX-Q806-28-SS	28		30.7				M42X2	27	38	13	46.5	19	4	41	
32	JX-Q806-32-ST	JX-Q806-32-SS	32		35												

Q807 Cone Connectors - Male elbow - Body

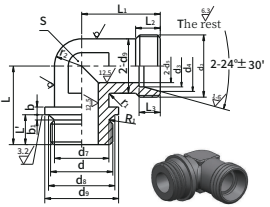

Standard: Q807
(GB/T 3738.2-1983)
Part Number Designation
JX-Q807 - 14 - ST
Type and Material: Steel(35)
Pipe Dia Code
Material Code

Part Number Designation
JX-Q807 - 14 - SS
Type and Material: Stainless steel
Pipe Dia Code
Material Code

Unit:mm

Nominal pressure (MPa)	pipe diameter D ₀	P/N		d ₃		d	d ₆	d ₇	d ₈	b	L ₁	L ₂	L ₃	L ₁	r ₂	r ₁	S	L			
		Steel	Stainless steel	Nominal size	Limit deviation														Nominal size	Limit deviation	
G (25)	4	JX-Q807-4-ST	JX-Q807-4-SS	4		6.1		6.5		8	1	8	M10X1	3	6.1	8	5.5	18.5	4	8	20
	5	JX-Q807-5-ST	JX-Q807-5-SS	5	+0.28	7.1							M12X1.25	3.5	7.1	10	7	20	5	10	22
	6	JX-Q807-6-ST	JX-Q807-6-SS	6	+0.21	8.1							M14X1.5	6	10.1	11	8.5	24.5	5.5	15	28
	8	JX-Q807-8-ST	JX-Q807-8-SS	8		10.1							M16X1.5	8	12.3	13	26	6.5	15	29	
	10	JX-Q807-10-ST	JX-Q807-10-SS	10		12.3							M18X1.5	10	14.3	15	27.5	7.5	15	31	
	12	JX-Q807-12-ST	JX-Q807-12-SS	12		14.3		4	4	1.2			M20X1.5	12	16.3	17	28.5	8.5	18	32	
	14	JX-Q807-14-ST	JX-Q807-14-SS	14		16.3							M22X1.5	14	18.3	19	30.5	9.5	21	36	
	16	JX-Q807-16-ST	JX-Q807-16-SS	16	+0.40	18.3							M24X1.5	15	20.3	21	30.5	10.5	21	38	
	18	JX-Q807-18-ST	JX-Q807-18-SS	18	+0.30	20.3							M27X1.5	17	22.7	24	34	12	3	41	
	20	JX-Q807-20-ST	JX-Q807-20-SS	20		22.7							M30X2	19	24.7	26	38	13	3	43	
	22	JX-Q807-22-ST	JX-Q807-22-SS	22		24.7							M33X2	22	27.7	30	40.5	15	30	48	
	25	JX-Q807-25-ST	JX-Q807-25-SS	25		27.7							M36X2	24	30.7	32	46.5	16	34		
28	JX-Q807-28-ST	JX-Q807-28-SS	28		30.7							M42X2	27	35	38	13	10.5	46.5	19	4	55
32	JX-Q807-32-ST	JX-Q807-32-SS	32		35																

AX AUTOMOTIVE FASTENERS SERIES

Q808 24° Cone Connectors - Male - Body

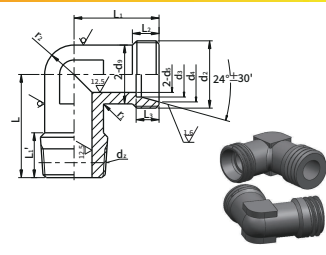

Standard: Q808
(QC/T 401-1999)
Part Number Designation
JX-Q808 - 14 - ST
Type and Material: Steel(35)
Pipe Dia Code
Material Code

Part Number Designation
JX-Q808 - 14 - SS
Type and Material: Stainless steel
Pipe Dia Code
Material Code

Unit:mm

Nominal pressure (Mpa)	pipe diameter D ₀	P/N		d ₃		d ₂	d ₅	L ₁	L	d ₂	d ₄ +0.10 -0	d ₉	L ₂	L ₃ +0.3 -0	L ₁	r ₂	r ₁	S
		Steel	Stainless steel	Nominal size	Limit deviation													
E (16)	4	JX-Q808-4-ST	JX-Q808-4-SS	4		3		10	20	M10X1	6.1	8	5.5	6.5	18.5	4		8
	5	JX-Q808-5-ST	JX-Q808-5-SS	5	+0.28	3.5				NPT 1/8	7.1	10	7	20	5			10
	6	JX-Q808-6-ST	JX-Q808-6-SS	6	+0.21	4					8.1	10	8.5	24.5	5.5	2		11
	8	JX-Q808-8-ST	JX-Q808-8-SS	8		6				NPT 1/4	10.1	11	8.5	26	6.5			15
	10	JX-Q808-10-ST	JX-Q808-10-SS	10		8					12.3	13	9	27.5	7.5			18
	12	JX-Q808-12-ST	JX-Q808-12-SS	12		10				NPT 3/8	14.3	15	9	30.5	8.5			21
	14	JX-Q808-14-ST	JX-Q808-14-SS	14		12					16.3	17	8.5	34	12	3		24
	16	JX-Q808-16-ST	JX-Q808-16-SS	16	+0.40	14				NPT 1/2	18.3	19	12	38	13			27
	18	JX-Q808-18-ST	JX-Q808-18-SS	18	+0.30	15					20.3	21	9.5	40.5	15	30		30
	20	JX-Q808-20-ST	JX-Q808-20-SS	20		17				NPT 3/4	22.7	24	12	46.5	16	34		34
	22	JX-Q808-22-ST	JX-Q808-22-SS	22		19					24.7	26	10.5	48	16	4		38
	25	JX-Q808-25-ST	JX-Q808-25-SS	25		22				NPT 1	27.7	30	12	55	17	4		41
28	JX-Q808-28-ST	JX-Q808-28-SS	28		24					30.7	32	13	10.5	46.5	19	4	41	
32	JX-Q808-32-ST	JX-Q808-32-SS	32		27				NPT 1 1/4	35	38	13	10.5	46.5	19	4	41	

Non-soldering compression fittings with cutting ring for screwed connections with tapered screw-in spigot form C according to DIN 3852-1 and DIN 3852-2

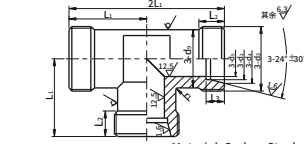

Standard: Q809
(GB/T 3745.2-1983)
Part Number Designation
JX-Q809 - 14 - ST
Type and Material: Steel(35)
Pipe Dia Code
Material Code

Part Number Designation
JX-Q809 - 14 - SS
Type and Material: Stainless steel
Pipe Dia Code
Material Code

Material: Carbon Steel
Thread: tolerance 6g, standard GB/T 196, GB/T 197
Remarks: There should be no cracks, pores, burrs, sharp edges, rust spots and other defects that affect the use.
Acceptance and packaging: according to GB/T 90.1, GB/T 90.2, where thread AQL=1.5, ferrule end size AQL=1.5, and other sizes AQL=4.0. When there are special requirements, it shall be negotiated by both parties.

Unit:mm

Nominal pressure (MPa)	pipe diameter D ₀	P/N		d ₃		d ₄		L ₃		d ₂	d ₅	d ₉	L ₂	L ₁	r ₁	S
		Steel	Stainless steel	Nominal size	Limit deviation	Nominal size	Limit deviation									
G (25)	4	JX-Q809-4-ST	JX-Q809-4-SS	4		6.1		6.5		M10X1	3	8	5.5	18.5		8
	5	JX-Q809-5-ST	JX-Q809-5-SS	5	+0.28	7.1		7		M12X1.25	3.5	10	7	20		10
	6	JX-Q809-6-ST	JX-Q809-6-SS	6	+0.21	8.1				M14X1.5	6	11	8.5	24.5		11
	8	JX-Q809-8-ST	JX-Q809-8-SS	8		10.1				M16X1.5	8	13	26	6.5		15
	10	JX-Q809-10-ST	JX-Q809-10-SS	10		12.3				M18X1.5	10	15	27.5	7.5		18
	12	JX-Q809-12-ST	JX-Q809-12-SS	12		14.3				M20X1.5	12	17	28.5	8.5		21
	14	JX-Q809-14-ST	JX-Q809-14-SS	14		16.3				M22X1.5	14	19	30.5	9.5		24
	16	JX-Q809-16-ST	JX-Q809-16-SS	16	+0.10	18.3	+0.10			M24X1.5	15	21	34	10.5		27
	18	JX-Q809-18-ST	JX-Q809-18-SS	18	+0.40	20.3	-0			M27X1.5	17	24	38	12	3	30
	20	JX-Q809-20-ST	JX-Q809-20-SS	20	+0.30	22.7				M30X2	19	26	40.5	13		34
	22	JX-Q809-22-ST	JX-Q809-22-SS	22		24.7				M33X2	22	30	46.5	15	30	48
	25	JX-Q809-25-ST	JX-Q809-25-SS	25		27.7				M36X2	24	32		16		34
28	JX-Q809-28-ST	JX-Q809-28-SS	28		30.7				M42X2	27	38	13	46.5	19	4	55
32	JX-Q809-32-ST	JX-Q809-32-SS	32		35											