

JX STAMPING FASTENERS SERIES

JX-Q430 Circlip for hole

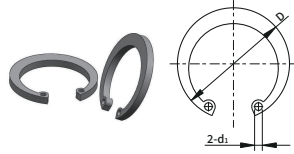

Material: Carbon spring steel,
65Mn, Stainless steel

Standard: Q430
(GB/T 893.1-1986)

Part Number Designation
JX-Q430 - 8 - 65Mn

Type and Material: 65Mn
Size Code: 8
Material Code: 65Mn

Part Number Designation
JX-Q430S - 8 - SS

Type and Material: Stainless Steel
Size Code: 8
Material Code: SS

Unit:mm

Unit:mm

Hole DIA d ₀	P/N		D		S		d ₁
	65Mn	Stainless steel	Basic size	Limit deviation	Basic size	Limit deviation	
8	JX-Q430-8-Mn	JX-Q430-8-SS	8.7		0.6	+0 -0.05	1
9	JX-Q430-9-Mn	JX-Q430-9-SS	9.8				
10	JX-Q430-10-Mn	JX-Q430-10-SS	10.8				
11	JX-Q430-11-Mn	JX-Q430-11-SS	11.8				
12	JX-Q430-12-Mn	JX-Q430-12-SS	13	+0.36	0.8		1.5
13	JX-Q430-13-Mn	JX-Q430-13-SS	14.1	-0.10			
14	JX-Q430-14-Mn	JX-Q430-14-SS	15.1				
15	JX-Q430-15-Mn	JX-Q430-15-SS	16.2				
16	JX-Q430-16-Mn	JX-Q430-16-SS	17.3				
17	JX-Q430-17-Mn	JX-Q430-17-SS	18.3				
18	JX-Q430-18-Mn	JX-Q430-18-SS	19.5	+0.42	1		
19	JX-Q430-19-Mn	JX-Q430-19-SS	20.5	-0.13			
20	JX-Q430-20-Mn	JX-Q430-20-SS	21.5				
21	JX-Q430-21-Mn	JX-Q430-21-SS	22.5				
22	JX-Q430-22-Mn	JX-Q430-22-SS	23.5				
24	JX-Q430-24-Mn	JX-Q430-24-SS	25.9	+0.42	2		
25	JX-Q430-25-Mn	JX-Q430-25-SS	26.9	-0.13			
26	JX-Q430-26-Mn	JX-Q430-26-SS	27.9				
28	JX-Q430-28-Mn	JX-Q430-28-SS	30.1				
30	JX-Q430-30-Mn	JX-Q430-30-SS	32.1				
31	JX-Q430-31-Mn	JX-Q430-31-SS	33.4				
32	JX-Q430-32-Mn	JX-Q430-32-SS	34.4	+0.50	2.5		
34	JX-Q430-34-Mn	JX-Q430-34-SS	36.5	-0.25			
35	JX-Q430-35-Mn	JX-Q430-35-SS	37.8				
36	JX-Q430-36-Mn	JX-Q430-36-SS	38.8				
37	JX-Q430-37-Mn	JX-Q430-37-SS	39.8				
38	JX-Q430-38-Mn	JX-Q430-38-SS	40.8				
40	JX-Q430-40-Mn	JX-Q430-40-SS	43.5	+0.90	1.5	+0 -0.11	3.0
42	JX-Q430-42-Mn	JX-Q430-42-SS	45.5	-0.39			
45	JX-Q430-45-Mn	JX-Q430-45-SS	48.5				
47	JX-Q430-47-Mn	JX-Q430-47-SS	50.5	+1.10			
48	JX-Q430-48-Mn	JX-Q430-48-SS	51.5	-0.46	2	+0 -0.13	
50	JX-Q430-50-Mn	JX-Q430-50-SS	54.2				
52	JX-Q430-52-Mn	JX-Q430-52-SS	56.2				

Hole Dia d ₀	P/N		D		S		d ₁
	65Mn	Stainless steel	Basic size	Limit deviation	Basic size	Limit deviation	
56	JX-Q430-56-Mn	JX-Q430-56-SS	59.2				
56	JX-Q430-56-Mn	JX-Q430-56-SS	60.2				
58	JX-Q430-58-Mn	JX-Q430-58-SS	62.2				
60	JX-Q430-60-Mn	JX-Q430-60-SS	64.2				
62	JX-Q430-62-Mn	JX-Q430-62-SS	66.2				
63	JX-Q430-63-Mn	JX-Q430-63-SS	67.2	+1.10	2	+0 -0.13	
65	JX-Q430-65-Mn	JX-Q430-65-SS	69.2	-0.46			
68	JX-Q430-68-Mn	JX-Q430-68-SS	72.5				
70	JX-Q430-70-Mn	JX-Q430-70-SS	74.5				
72	JX-Q430-72-Mn	JX-Q430-72-SS	76.5				
75	JX-Q430-75-Mn	JX-Q430-75-SS	79.5				
78	JX-Q430-78-Mn	JX-Q430-78-SS	82.5				
80	JX-Q430-80-Mn	JX-Q430-80-SS	85.5				
82	JX-Q430-82-Mn	JX-Q430-82-SS	87.5				
85	JX-Q430-85-Mn	JX-Q430-85-SS	90.5				
88	JX-Q430-88-Mn	JX-Q430-88-SS	93.5	+1.30	2.5		
90	JX-Q430-90-Mn	JX-Q430-90-SS	95.5	-0.54			
92	JX-Q430-92-Mn	JX-Q430-92-SS	97.5				
95	JX-Q430-95-Mn	JX-Q430-95-SS	100.5				
98	JX-Q430-98-Mn	JX-Q430-98-SS	103.5				
100	JX-Q430-100-Mn	JX-Q430-100-SS	105.5			+0 -0.16	
102	JX-Q430-102-Mn	JX-Q430-102-SS	108				
105	JX-Q430-105-Mn	JX-Q430-105-SS	112				
108	JX-Q430-108-Mn	JX-Q430-108-SS	115				
110	JX-Q430-110-Mn	JX-Q430-110-SS	117				
112	JX-Q430-112-Mn	JX-Q430-112-SS	119				
115	JX-Q430-115-Mn	JX-Q430-115-SS	122	+1.50	3.0		
120	JX-Q430-120-Mn	JX-Q430-120-SS	127	-0.63			
125	JX-Q430-125-Mn	JX-Q430-125-SS	132				
130	JX-Q430-130-Mn	JX-Q430-130-SS	137				
135	JX-Q430-135-Mn	JX-Q430-135-SS	142				
140	JX-Q430-140-Mn	JX-Q430-140-SS	147				
145	JX-Q430-145-Mn	JX-Q430-145-SS	152				
150	JX-Q430-150-Mn	JX-Q430-150-SS	158				

JX-Q431 Circlip for shaft

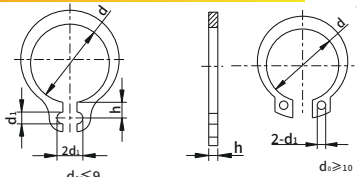

Material: Carbon spring steel,
65Mn, Stainless steel

Standard: Q431
(GB/T 894.1-1986)

Part Number Designation
JX-Q431 - 30 - 65Mn

Type and Material: 65Mn
Size Code: 30
Material Code: 65Mn

Part Number Designation
JX-Q431 - 30 - SS

Type and Material: Stainless Steel
Size Code: 30
Material Code: SS

JX STAMPING FASTENERS SERIES

Q436 Lock washers (retaining washers for shafts)

Shaft Dia d ₀	P/N		d	S		d ₁
	65Mn	Stainless steel		Basic size	Limit deviation	
3	JX-Q431-3-Mn	JX-Q431-3-SS	2.7			
4	JX-Q431-4-Mn	JX-Q431-4-SS	3.7	+0.04	0.4	1
5	JX-Q431-5-Mn	JX-Q431-5-SS	4.7	-0.15		
6	JX-Q431-6-Mn	JX-Q431-6-SS	5.6		0.6	
7	JX-Q431-7-Mn	JX-Q431-7-SS	6.5	+0.06		1.2
8	JX-Q431-8-Mn	JX-Q431-8-SS	7.4	-0.18	0.8	
9	JX-Q431-9-Mn	JX-Q431-9-SS	8.4			
10	JX-Q431-10-Mn	JX-Q431-10-SS	9.3			
11	JX-Q431-11-Mn	JX-Q431-11-SS	10.2			1.5
12	JX-Q431-12-Mn	JX-Q431-12-SS	11			
13	JX-Q431-13-Mn	JX-Q431-13-SS	11.9			
14	JX-Q431-14-Mn	JX-Q431-14-SS	12.9	+0.10		
15	JX-Q431-15-Mn	JX-Q431-15-SS	13.8	-0.36		
16	JX-Q431-16-Mn	JX-Q431-16-SS	14.7			1.7
17	JX-Q431-17-Mn	JX-Q431-17-SS	15.7			
18	JX-Q431-18-Mn	JX-Q431-18-SS	16.5			
19	JX-Q431-19-Mn	JX-Q431-19-SS	17.5			
20	JX-Q431-20-Mn	JX-Q431-20-SS	18.5	+0.13		
21	JX-Q431-21-Mn	JX-Q431-21-SS	19.5	-0.42		
22	JX-Q431-22-Mn	JX-Q431-22-SS	20.5			
24	JX-Q431-24-Mn	JX-Q431-24-SS	22.2			2
25	JX-Q431-25-Mn	JX-Q431-25-SS	23.2			
26	JX-Q431-26-Mn	JX-Q431-26-SS	24.2			
28	JX-Q431-28-Mn	JX-Q431-28-SS	25.9	+0.21	1.2	
30	JX-Q431-30-Mn	JX-Q431-30-SS	26.9	-0.42		
31	JX-Q431-31-Mn	JX-Q431-31-SS	27.9			
32	JX-Q431-32-Mn	JX-Q431-32-SS	29.6			
34	JX-Q431-34-Mn	JX-Q431-34-SS	31.5			
35	JX-Q431-35-Mn	JX-Q431-35-SS	32.2			
36	JX-Q431-36-Mn	JX-Q431-36-SS	33.2	+0.25	1.5	2.5
37	JX-Q431-37-Mn	JX-Q431-37-SS	34.2	-0.50		
38	JX-Q431-38-Mn	JX-Q431-38-SS	35.2			
40	JX-Q431-40-Mn	JX-Q431-40-SS	36.5	+0.39		
42	JX-Q431-42-Mn	JX-Q431-42-SS	38.5	-0.90		3

Q436 Lock washers (retaining washers for shafts)

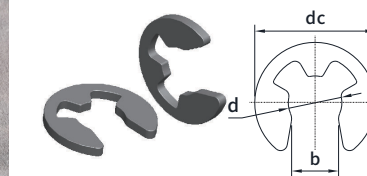

Material: Carbon spring steel,
65Mn, Stainless steel

Standard: Q436
(GB/T 896-1986)

Part Number Designation
JX-GB896 - D1.2 - 65Mn

Type and Material: Carbon spring steel
Size Code: D1.2
Material Code: 65Mn

Part Number Designation
JX-GB896 - D1.2 - SS

Type and Material: Stainless steel
Size Code: D1.2
Material Code: SS

Unit:mm

Ring		Trench (recommended)		Shaft diameter d ₀
Basic size	Limit deviation	Basic size	Limit deviation	
1.2		3	0.4	1
1.5		4	0.5	
2	+0 -0.14	5	-0	1.2
2.5		6	0.7	
3		7	0.9	1.5
3.5		8	1.1	
4	+0	9	-0	2
5	-0.18	10	1.3	
6		12	+0.11	2.5
8	+0	16	-0	
9	-0.22	18	1.6	3
12	+0	24	-0	
15	-0.27	30	1.6	