

# STAMPING FATENTERS SERIES

## Q419 Countersunk spring washers

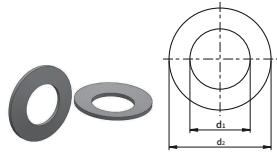
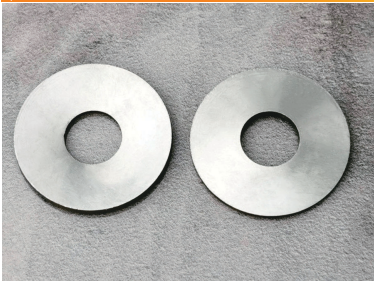

Material: carbon steel, 65Mn, stainless steel, brass, copper

Standard: Q419 (QC/T 601-1999)

Part Number Designation  
JX-Q419 - 8 - ST  
Type and Material Code: Carbon Steel

Part Number Designation  
JX-Q419 - 8 - SS  
Type and Material Code: Stainless Steel

Thread Size d	P/N			d <sub>1</sub>		d <sub>2</sub>		h		t		Elasticity N	Clamping force N
	Carbon Steel	65Mn	Stainless steel	max	min	max	min	max	min	max	min		
4	JX-Q419-4-ST	JX-Q419-4-65Mn	JX-Q419-4-SS	4.6	4.3	9	8.64	1.3	1.12	1	0.91	3770	4000
5	JX-Q419-5-ST	JX-Q419-5-65Mn	JX-Q419-5-SS	5.6	5.3	11	10.57	1.55	1.35	1.2	1.11	5480	6500
6	JX-Q419-6-ST	JX-Q419-6-65Mn	JX-Q419-6-SS	6.76	6.4	14	13.57	2	1.7	1.5	1.39	8590	9250
8	JX-Q419-8-ST	JX-Q419-8-65Mn	JX-Q419-8-SS	8.75	8.4	18	17.57	2.6	2.24	2	1.87	14900	17000
10	JX-Q419-10-ST	JX-Q419-10-65Mn	JX-Q419-10-SS	10.93	10.5	23	22.48	3.2	2.8	2.5	2.34	22100	27100
12	JX-Q419-12-ST	JX-Q419-12-65Mn	JX-Q419-12-SS	13.43	13	29	28.48	3.95	3.43	3	2.84	34100	39500
14	JX-Q419-14-ST	JX-Q419-14-65Mn	JX-Q419-14-SS	15.43	15	35	34.38	4.65	4.04	3.5	3.3	46000	54000
16	JX-Q419-16-ST	JX-Q419-16-65Mn	JX-Q419-16-SS	17.43	17	39	38.38	5.25	4.58	4	3.8	59700	75000
18	JX-Q419-18-ST	JX-Q419-18-65Mn	JX-Q419-18-SS	19.52	19	42	41.38	5.8	5.08	4.5	4.25	74400	90500
20	JX-Q419-20-ST	JX-Q419-20-65Mn	JX-Q419-20-SS	21.52	21	45	44.38	6.4	5.6	5	4.75	932000	117000
22	JX-Q419-22-ST	JX-Q419-22-65Mn	JX-Q419-22-SS	23.52	23	49	48.38	7.05	6.15	5.5	5.2	113700	145000
24	JX-Q419-24-ST	JX-Q419-24-65Mn	JX-Q419-24-SS	25.52	25	56	55.26	7.75	6.77	6	5.7	131000	169000
27	JX-Q419-27-ST	JX-Q419-27-65Mn	JX-Q419-27-SS	28.52	28	60	59.26	8.35	7.3	6.5	6.2	154000	221000
30	JX-Q419-30-ST	JX-Q419-30-65Mn	JX-Q419-30-SS	31.52	31	70	69.26	9.2	8	7	6.7	172000	269000

Remark: 1) Compression force is the pressure of 8.8 bolts, applied to elastic test;  
2) Elasticity is the elasticity of a flat state.

## DIN 6908 Conical Spring Washers For Screw And Washer Assemblies

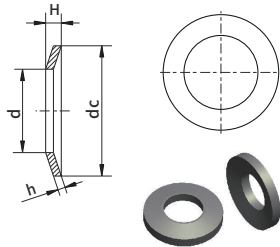

Material: carbon steel, 65Mn, SK5, SK7, stainless steel, brass, copper

Part Number Designation  
JX-DIN6908 - D3.6 - 65MN

Type and Material Code: 65MN

Part Number Designation  
JX-DIN6908 - D3.6 - SK5

Standard: Q420, DIN6908 (QC/T 600-1999)

Size D	P/N				d		dc		h	H		Suitable thread
	65MN	Sk5	Sk7	Stainless steel	min	max	min	max		min	max	
2.35	JX-DIN6908-D2.35-65MN	JX-DIN6908-D2.35-SK5	JX-DIN6908-D2.35-SK7	JX-DIN6908-D2.35-SS	2.25	2.35	5.7	6	0.5	0.61	0.72	M2.5
2.75	JX-DIN6908-D2.75-65MN	JX-DIN6908-D2.75-SK5	JX-DIN6908-D2.75-SK7	JX-DIN6908-D2.75-SS	2.75	2.85	6.64	7	0.6	0.72	0.85	M3
3.20	JX-DIN6908-D3.2-65MN	JX-DIN6908-D3.2-SK5	JX-DIN6908-D3.2-SK7	JX-DIN6908-D3.2-SS	3.20	3.32	7.64	8	0.8	0.92	1.06	M3.5
3.60	JX-DIN6908-D3.6-65MN	JX-DIN6908-D3.6-SK5	JX-DIN6908-D3.6-SK7	JX-DIN6908-D3.6-SS	3.60	3.72	8.64	9	1	1.12	1.30	M4
4.55	JX-DIN6908-D4.55-65MN	JX-DIN6908-D4.55-SK5	JX-DIN6908-D4.55-SK7	JX-DIN6908-D4.55-SS	4.55	4.67	10.57	11	1.2	1.35	1.55	M5
5.50	JX-DIN6908-D5.5-65MN	JX-DIN6908-D5.5-SK5	JX-DIN6908-D5.5-SK7	JX-DIN6908-D5.5-SS	5.50	5.62	13.57	14	1.5	1.70	2	M6
7.40	JX-DIN6908-D7.4-65MN	JX-DIN6908-D7.4-SK5	JX-DIN6908-D7.4-SK7	JX-DIN6908-D7.4-SS	7.40	7.55	17.57	18	2	2.24	2.6	M8
9.3	JX-DIN6908-D9.3-65MN	JX-DIN6908-D9.3-SK5	JX-DIN6908-D9.3-SK7	JX-DIN6908-D9.3-SS	9.3	9.45	22.48	23	2.5	2.8	3.2	M10
11	JX-DIN6908-D11-65MN	JX-DIN6908-D11-SK5	JX-DIN6908-D11-SK7	JX-DIN6908-D11-SS	11	11.18	28.48	29	3	3.43	3.95	M12

# STAMPING FATENTERS SERIES

## Q421 Plain washer for tapping screw assembly

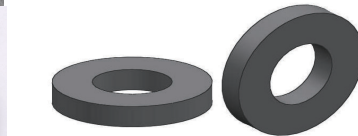
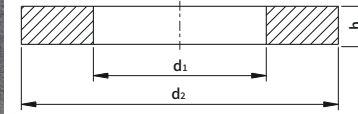

Material: carbon steel, 65Mn, stainless steel, brass, copper

Standard: Q421 (GB/T 9074.29-1988)

Part Number Designation  
JX-Q421 - 4.2 - ST  
Type and Material Code: Carbon Steel

Part Number Designation  
JX-Q421 - 4.2 - SS  
Type and Material Code: Stainless Steel

Thread Size d	P/N			d <sub>1</sub>		d <sub>2</sub>			h		
	Carbon steel	Stainless steel	Copper	max	min	公称 Nominal	max	min	Nominal	max	min
2.9	JX-Q421-2.9-ST	JX-Q421-2.9-SS	JX-Q421-2.9-Co	2.56	2.46	6	6	5.70	0.8	0.9	0.7
3.5	JX-Q421-3.5-ST	JX-Q421-3.5-SS	JX-Q421-3.5-Co	3.10	3.00	8	8	7.64	1.0	1.1	0.9
4.2	JX-Q421-4.2-ST	JX-Q421-4.2-SS	JX-Q421-4.2-Co	3.67	3.55	9	9	8.64	1.0	1.1	0.9
4.8	JX-Q421-4.8-ST	JX-Q421-4.8-SS	JX-Q421-4.8-Co	4.18	4.06	10	10	9.64	1.0	1.1	0.9
5.5	JX-Q421-5.5-ST	JX-Q421-5.5-SS	JX-Q421-5.5-Co	4.82	4.70	12	12	11.57	1.6	1.8	1.4
6.3	JX-Q421-6.3-ST	JX-Q421-6.3-SS	JX-Q421-6.3-Co	5.58	5.46	14	14	13.57	1.6	1.8	1.4
8	JX-Q421-8-ST	JX-Q421-8-SS	JX-Q421-8-Co	7.27	7.15	14	14	13.57	1.6	1.8	1.4

## Q422 Large plain washers for self-tapping screws

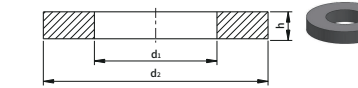

Material: carbon steel, 65Mn, stainless steel, brass, copper

Standard: Q422 (GB/T 9074.30-1988)

Part Number Designation  
JX-Q422 - 4.2 - ST  
Type and Material Code: Carbon Steel

Part Number Designation  
JX-Q422 - 4.2 - SS  
Type and Material Code: Stainless Steel

Thread Size d	料号 P/N			d <sub>1</sub>		d <sub>2</sub>			h		
	Carbon steel	Stainless steel	Copper	max	min	Nom	max	min	Nom	max	min
2.9	JX-Q422-2.9-ST	JX-Q422-2.9-SS	JX-Q422-2.9-Co	2.56	2.46	9	9	8.64	1.0	1.1	0.9
3.5	JX-Q422-3.5-ST	JX-Q422-3.5-SS	JX-Q422-3.5-Co	3.12	3.00	11	11	10.57	1.0	1.1	0.9
4.2	JX-Q4221-4.2-ST	JX-Q4221-4.2-SS	JX-Q4221-4.2-Co	3.67	3.55	12	12	11.57	1.0	1.1	0.9
4.8	JX-Q422-4.8-ST	JX-Q422-4.8-SS	JX-Q422-4.8-Co	4.12	4.00	15	15	14.57	1.6	1.8	1.4
5.5	JX-Q422-5.5-ST	JX-Q422-5.5-SS	JX-Q422-5.5-Co	4.82	4.70	15	15	14.57	1.6	1.8	1.4
6.3	JX-Q422-6.3-ST	JX-Q422-6.3-SS	JX-Q422-6.3-Co	5.52	5.40	18	18	17.57	1.6	1.8	1.4
8	JX-Q422-8-ST	JX-Q422-8-SS	JX-Q422-8-Co	7.27	7.15	21	21	20.48	2.0	2.2	1.8