

PIN FASTENERS SERIES

JX-GB/T 880-2008 Headless pin shaft (pin with hole)

Standard: GB/T880-2008

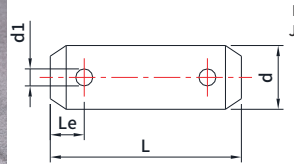

Part Number Designation
JX-GB880 - ϕ 3 - L - ST
Type and Material Code Size Long Material Code Code Code
Material:Steel

Part Number Designation
JX-GB880 - ϕ 3 - L - SS
Type and Material Code Size Long Material Code Code Code
Material:Stainless steel

Material:Carbon Steel,
Stainless Steel

Unit:mm

Size	P/N		d		d1		Le
	Carbon Steel	Stainless Steel	max	min	max	min	
ϕ 3	JX-GB880- ϕ 3-L-ST	JX-GB880- ϕ 3-L-SS	3	2.94	0.94	0.8	1.6
ϕ 4	JX-GB880- ϕ 4-L-ST	JX-GB880- ϕ 4-L-SS	4	3.925	1.14	1	2.2
ϕ 5	JX-GB880- ϕ 5-L-ST	JX-GB880- ϕ 5-L-SS	5	4.925	1.34	1.2	2.9
ϕ 6	JX-GB880- ϕ 6-L-ST	JX-GB880- ϕ 6-L-SS	6	5.925	1.74	1.6	3.2
ϕ 8	JX-GB880- ϕ 8-L-ST	JX-GB880- ϕ 8-L-SS	8	7.91	2.14	2	3.5
ϕ 10	JX-GB880- ϕ 10-L-ST	JX-GB880- ϕ 10-L-SS	10	9.91	3.38	3.2	4.5
ϕ 12	JX-GB880- ϕ 12-L-ST	JX-GB880- ϕ 12-L-SS	12	11.89	3.38	3.2	5.5
ϕ 14	JX-GB880- ϕ 14-L-ST	JX-GB880- ϕ 14-L-SS	14	13.89	4.18	4	6
ϕ 16	JX-GB880- ϕ 16-L-ST	JX-GB880- ϕ 16-L-SS	16	15.89	4.18	4	6
ϕ 18	JX-GB880- ϕ 18-L-ST	JX-GB880- ϕ 18-L-SS	18	17.89	5.18	5	7
ϕ 20	JX-GB880- ϕ 20-L-ST	JX-GB880- ϕ 20-L-SS	20	19.87	5.18	5	8
ϕ 22	JX-GB880- ϕ 22-L-ST	JX-GB880- ϕ 22-L-SS	22	21.87	5.18	5	8
ϕ 24	JX-GB880- ϕ 24-L-ST	JX-GB880- ϕ 24-L-SS	24	23.87	6.52	6.3	9
ϕ 27	JX-GB880- ϕ 27-L-ST	JX-GB880- ϕ 27-L-SS	27	26.87	6.52	6.3	9
ϕ 30	JX-GB880- ϕ 30-L-ST	JX-GB880- ϕ 30-L-SS	30	29.87	8.22	8	10
ϕ 33	JX-GB880- ϕ 33-L-ST	JX-GB880- ϕ 33-L-SS	33	32.84	8.22	8	10
ϕ 36	JX-GB880- ϕ 36-L-ST	JX-GB880- ϕ 36-L-SS	36	35.84	8.22	8	10
ϕ 40	JX-GB880- ϕ 40-L-ST	JX-GB880- ϕ 40-L-SS	40	39.84	8.22	8	10
ϕ 45	JX-GB880- ϕ 45-L-ST	JX-GB880- ϕ 45-L-SS	45	44.84	10.22	10	12
ϕ 50	JX-GB880- ϕ 50-L-ST	JX-GB880- ϕ 50-L-SS	50	49.84	10.22	10	12
ϕ 55	JX-GB880- ϕ 55-L-ST	JX-GB880- ϕ 55-L-SS	55	54.81	10.22	10	14
ϕ 60	JX-GB880- ϕ 60-L-ST	JX-GB880- ϕ 60-L-SS	60	59.81	10.22	10	14
ϕ 70	JX-GB880- ϕ 70-L-ST	JX-GB880- ϕ 70-L-SS	70	69.81	13.27	13	16
ϕ 80	JX-GB880- ϕ 80-L-ST	JX-GB880- ϕ 80-L-SS	80	79.81	13.27	13	16
ϕ 90	JX-GB880- ϕ 90-L-ST	JX-GB880- ϕ 90-L-SS	90	89.78	13.27	13	16
ϕ 100	JX-GB880- ϕ 100-L-ST	JX-GB880- ϕ 100-L-SS	100	99.78	13.27	13	16

JX-DIN 1481-1978 Elastic cylindrical pin, heavy duty

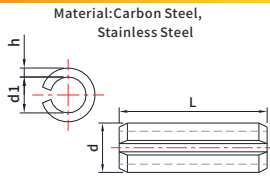

Material:Carbon Steel,
Stainless Steel

Part Number Designation
JX-DIN1481 - 1 - L - ST
Type and Material Code Size Long Material Code Code Code
Material:Steel

Part Number Designation
JX-DIN1481-1-L-SS
Type and Material Code Size Long Material Code Code Code
Material:Stainless steel

Unit:mm

Size	P/N		Nom Dia d	h	d min	d1 \approx
	Carbon Steel	Stainless Steel				
1	JX-DIN1481-1-L-ST	JX-DIN1481-1-L-SS	1	0.2	1.2	0.8
1.5	JX-DIN1481-1.5-L-ST	JX-DIN1481-1.5-L-SS	1.5	0.3	1.7	1.1
2	JX-DIN1481-2-L-ST	JX-DIN1481-2-L-SS	2	0.4	2.3	1.5
2.5	JX-DIN1481-2.5-L-ST	JX-DIN1481-2.5-L-SS	2.5	0.5	2.8	1.8
3	JX-DIN1481-3-L-ST	JX-DIN1481-3-L-SS	3	0.6	3.3	2.1
4	JX-DIN1481-4-L-ST	JX-DIN1481-4-L-SS	4	0.8	4.4	2.8
5	JX-DIN1481-5-L-ST	JX-DIN1481-5-L-SS	5	1	5.4	3.4
6	JX-DIN1481-6-L-ST	JX-DIN1481-6-L-SS	6	1.25	6.4	4
8	JX-DIN1481-8-L-ST	JX-DIN1481-8-L-SS	8	1.5	8.5	5.5
10	JX-DIN1481-10-L-ST	JX-DIN1481-10-L-SS	10	2	10.5	6.5

Remark: Material and surface treatment or other specifications can also be manufactured according to customer requirements

PIN FASTENER SERIES

JX-GB/T 13829.3-2004 Grooved pin Middle length 1/3 Total length

Standard: GB/T13829.3-2004

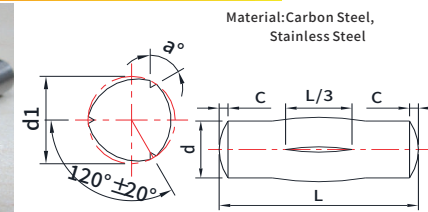

Material:Carbon Steel,
Stainless Steel

Part Number Designation
JX-GB13829 - 1.5 - L - ST
Type and Material Code Size Long Material Code Code Code
Material:Steel

Part Number Designation
JX-GB13829 - 1.5 - L - SS
Type and Material Code Size Long Material Code Code Code
Material:Stainless steel

Unit:mm

Size	P/N		d		c	Minimum shear load/KN-Double shear
	Carbon Steel	Stainless Steel	max	min		
1.5	JX-GB13829.36-1.5-L-ST	JX-GB13829.36-1.5-L-SS	1.5	1.475	0.2	1.6
2	JX-GB13829.3-2-L-ST	JX-GB13829.3-2-L-SS	2	1.975	0.25	2.84
2.5	JX-GB13829.3-2.5-L-ST	JX-GB13829.3-2.5-L-SS	2.5	2.475	0.3	4.4
3	JX-GB13829.3-3-L-ST	JX-GB13829.3-3-L-SS	3	2.975	0.4	6.4
4	JX-GB13829.3-4-L-ST	JX-GB13829.3-4-L-SS	4	3.925	0.5	11.3
5	JX-GB13829.3-5-L-ST	JX-GB13829.3-5-L-SS	5	4.925	0.63	17.6
6	JX-GB13829.3-6-L-ST	JX-GB13829.3-6-L-SS	6	5.925	0.8	25.4
8	JX-GB13829.3-8-L-ST	JX-GB13829.3-8-L-SS	8	7.91	1	45.2
10	JX-GB13829.3-10-L-ST	JX-GB13829.3-10-L-SS	10	9.91	1.2	70.4
12	JX-GB13829.3-12-L-ST	JX-GB13829.3-12-L-SS	12	11.89	1.6	101.8
16	JX-GB13829.3-16-L-ST	JX-GB13829.3-16-L-SS	16	15.89	2	181
20	JX-GB13829.3-20-L-ST	JX-GB13829.3-20-L-SS	20	19.87	2.5	283
25	JX-GB13829.3-25-L-ST	JX-GB13829.3-25-L-SS	25	19.87	3	444

JX-DIN 71803-1988 Spherical hinge

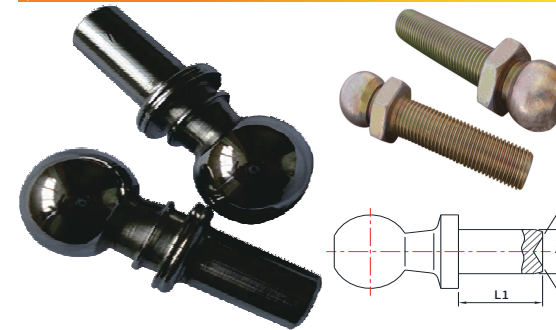

Material:Carbon Steel,
Stainless Steel

Part Number Designation
JX-DIN71803-4 - 6 - ST
Type and Material Code Size Long Material Code Code Code
Material:Carbon Steel

Part Number Designation
JX-DIN71803-4 - 6 - SS
Type and Material Code Size Long Material Code Code Code
Material:Stainless steel

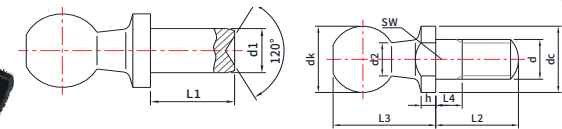

B Type

A,C Type

Unit:mm

Size	P/N		dk h10	L1 ± 0.2	h ± 0.4	dc h14 ± 0.2	d2 ± 0.3	L2 ± 0.3	L3 ± 0.3	L4 max	SW	1000Pcs/kg	
	Carbon Steel (A B C)	Stainless Steel (A B C)										A/C	B
/	4	JX-D71803-4-6-3.5-ST-(A/B/C)	JX-D71803-4-6-3.5-SS-(A/B/C)	6	3.5	2	6	3	/	9.2	/	/	1.9
M5	5	JX-D71803-M5-8-4-ST-(A/B/C)	JX-D71803-M5-8-4-SS-(A/B/C)	8	4	2	8	4	10.2	12.5	4	7	3.85
		JX-D71803-M5-8-7.5-ST-(A/B/C)	JX-D71803-M5-8-7.5-SS-(A/B/C)										4.35
M6	6	JX-D71803-M6-10-4.5-ST-(A/B/C)	JX-D71803-M6-10-4.5-SS-(A/B/C)	10	4.5	2.2	10	5	12.5	15.5	4	8	8.5
		JX-D71803-M6-10-8-ST-(A/B/C)	JX-D71803-M6-10-8-SS-(A/B/C)										7.8
M8	8	JX-D71803-M8-13-5-ST-(A/B/C)	JX-D71803-M8-13-5-SS-(A/B/C)	13	5	2.4	13	6.5	16.5	18.5	5.3	11	14.2
		JX-D71803-M8-13-10-ST-(A/B/C)	JX-D71803-M8-13-10-SS-(A/B/C)										16
M10	10	JX-D71803-M10-16-6-ST-(A/B/C)	JX-D71803-M10-16-6-SS-(A/B/C)	16	6	2.7	16	8	20	23	7.3	13	23.5
		JX-D71803-M10-16-13-ST-(A/B/C)	JX-D71803-M10-16-13-SS-(A/B/C)										19.6
M14x1.5	14	JX-D71803-M14-19-12-ST-(A/B/C)	JX-D71803-M14-19-12-SS-(A/B/C)	19	12	3	19	10	28	28.5	10.8	16	56.2
		JX-D71803-M14-19-18-ST-(A/B/C)	JX-D71803-M14-19-18-SS-(A/B/C)										63.7

Remark: Material and surface treatment or other specifications can also be manufactured according to customer requirements