

JX PIN FASTENERS SERIES

JX-Q524 Knurled cylindrical pin

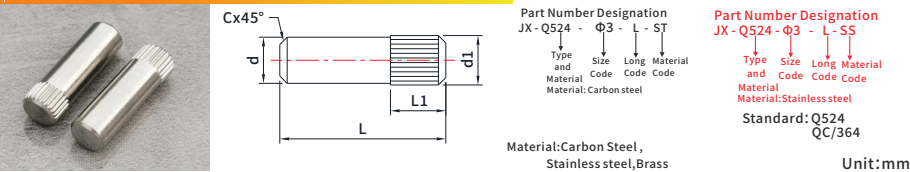

Part Number Designation
JX-Q524 - Φ3 - L - ST
 Type and Material Code: Carbon steel
 Size Code: Φ3
 Long Code: L
 Material Code: ST

Part Number Designation
JX-Q524 - Φ3 - L - SS
 Type and Material Code: Stainless steel
 Size Code: Φ3
 Long Code: L
 Material Code: SS

Standard: Q524 QC/364

Size	P/N			d				L1
	Carbon Steel	Stainless Steel	Brass	max	min	d1 min	L1	
Φ3	JX-Q524-Φ3-L-ST	JX-Q524-Φ3-L-SS	JX-Q524-Φ3-L-SS	3	2.96	3.12	6	
Φ4	JX-Q524-Φ4-L-ST	JX-Q524-Φ4-L-SS	JX-Q524-Φ4-L-SS	4	3.952	4.15	7	
Φ5	JX-Q524-Φ5-L-ST	JX-Q524-Φ5-L-SS	JX-Q524-Φ5-L-SS	5	4.952	5.15	8	
Φ6	JX-Q524-Φ6-L-ST	JX-Q524-Φ6-L-SS	JX-Q524-Φ6-L-SS	6	5.952	6.15	10	
Φ8	JX-Q524-Φ8-L-ST	JX-Q524-Φ8-L-SS	JX-Q524-Φ8-L-SS	8	7.942	8.17	10	
Φ10	JX-Q524-Φ10-L-ST	JX-Q524-Φ10-L-SS	JX-Q524-Φ10-L-SS	10	9.942	10.17	12	
Φ12	JX-Q524-Φ12-L-ST	JX-Q524-Φ12-L-SS	JX-Q524-Φ12-L-SS	12	11.93	12.2	12	

JX-DIN 7979-1977 Internal thread cylindrical pin

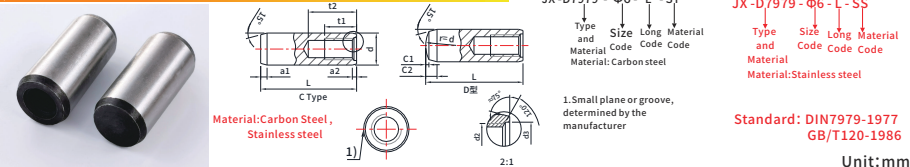

Part Number Designation
JX-D7979 - Φ6 - L - ST
 Type and Material Code: Carbon steel
 Size Code: Φ6
 Long Code: L
 Material Code: ST

Part Number Designation
JX-D7979 - Φ6 - L - SS
 Type and Material Code: Stainless steel
 Size Code: Φ6
 Long Code: L
 Material Code: SS

Standard: DIN7979-1977 GB/T120-1986

规格 Size	P/N		d		a1	a2	C1	C2	d2	d3	t1	t2
	Carbon Steel	Stainless Steel	max	min								
Φ6	JX-DIN7979-Φ6-M4-10-L-ST	JX-DIN7979-Φ6-M4-10-L-SS	6.012	6.004	1.2	0.8	0.6	2.1	M4	4.3	6	10
Φ8	JX-DIN7979-Φ8-M5-12-L-ST	JX-DIN7979-Φ8-M5-12-L-SS	8.015	8.006	1.6	1.0	0.8	2.6	M5	5.3	8	12
Φ10	JX-DIN7979-Φ10-M6-16-L-ST	JX-DIN7979-Φ10-M6-16-L-SS	10.015	10.006	2	1.2	1	3	M6	6.4	10	16
Φ12	JX-DIN7979-Φ12-M6-16-L-ST	JX-DIN7979-Φ12-M6-16-L-SS	12.018	12.007	2.5	1.6	1.2	3.8	M6	6.4	10	16
Φ14	JX-DIN7979-Φ14-M8-20-L-ST	JX-DIN7979-Φ14-M8-20-L-SS	14.018	14.007	2.5	1.8	1.4	4	M8	8.4	12	20
Φ16	JX-DIN7979-Φ16-M8-20-L-ST	JX-DIN7979-Φ16-M8-20-L-SS	16.018	16.007	3	2	1.6	4.7	M8	8.4	12	20
Φ20	JX-DIN7979-Φ20-M10-25-L-ST	JX-DIN7979-Φ20-M10-25-L-SS	20.021	20.008	3.5	2.5	2	6	M10	10.5	16	25
Φ25	JX-DIN7979-Φ25-M16-34-L-ST	JX-DIN7979-Φ25-M16-34-L-SS	25.021	25.008	4	3	2.5	6	M16	17	24	34
Φ30	JX-DIN7979-Φ30-M20-42-L-ST	JX-DIN7979-Φ30-M20-42-L-SS	30.021	30.008	5	4	3	7	M20	21	30	42
Φ40	JX-DIN7979-Φ40-M20-42-L-ST	JX-DIN7979-Φ40-M20-42-L-SS	40.025	40.009	6.3	5	4	8	M20	21	30	42
Φ50	JX-DIN7979-Φ50-M24-50-L-ST	JX-DIN7979-Φ50-M24-50-L-SS	50.025	50.009	8	6.3	5	10	M24	25	36	50
Φ60	JX-DIN7979-Φ60-M30-56-L-ST	JX-DIN7979-Φ60-M30-56-L-SS	60.03	60.011	10	8	6	12	M30	31	40	56
Φ70	JX-DIN7979-Φ70-M36-71-L-ST	JX-DIN7979-Φ70-M36-71-L-SS	70.03	70.011	12	10	7	14	M36	37	54	71
Φ80	JX-DIN7979-Φ80-M42-82-L-ST	JX-DIN7979-Φ80-M42-82-L-SS	80.03	80.011	14	12	8	16	M42	43	63	82

JX-Q 525 Taper pin

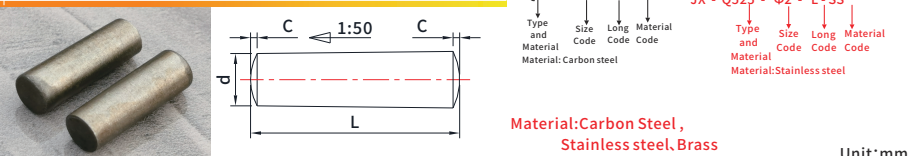

Part Number Designation
JX-Q525 - Φ2 - L - ST
 Type and Material Code: Carbon steel
 Size Code: Φ2
 Long Code: L
 Material Code: ST

Part Number Designation
JX-Q525 - Φ2 - L - SS
 Type and Material Code: Stainless steel
 Size Code: Φ2
 Long Code: L
 Material Code: SS

Material: Carbon Steel, Stainless steel, Brass

Size	P/N			d		C
	Carbon Steel	Stainless Steel	Brass	max	min	
Φ2	JX-Q525-Φ2-L-ST	JX-Q525-Φ2-L-SS	JX-Q525-Φ2-L-B	2	1.96	0.25
Φ3	JX-Q525-Φ3-L-ST	JX-Q525-Φ3-L-SS	JX-Q525-Φ3-L-B	3	2.96	0.4
Φ4	JX-Q525-Φ4-L-ST	JX-Q525-Φ4-L-SS	JX-Q525-Φ4-L-B	4	3.952	0.5
Φ5	JX-Q525-Φ5-L-ST	JX-Q525-Φ5-L-SS	JX-Q525-Φ5-L-B	5	4.952	0.63
Φ6	JX-Q525-Φ6-L-ST	JX-Q525-Φ6-L-SS	JX-Q525-Φ6-L-B	6	5.952	0.8

JX PIN FASTENERS SERIES

Size	P/N			d		C
	Carbon Steel	Stainless Steel	Brass	max	min	
Φ8	JX-Q525-Φ8-8-L-ST	JX-Q525-Φ8-8-L-SS	JX-Q525-Φ8-8-L-B	8	7.942	1
Φ10	JX-Q525-Φ10-10-L-ST	JX-Q525-Φ10-10-L-SS	JX-Q525-Φ10-10-L-B	10	9.942	1.2
Φ12	JX-Q525-Φ12-12-L-ST	JX-Q525-Φ12-12-L-SS	JX-Q525-Φ12-12-L-B	12	11.93	1.6
Φ16	JX-Q525-Φ16-16-L-ST	JX-Q525-Φ16-16-L-SS	JX-Q525-Φ16-16-L-B	16	15.93	2
Material	Brand standard	35(28HRC~38HRC), 45(38HRC~46HRC)		Y12, Y15		
		GB/T 699		GB/T 8731		
Taper	Taper tolerance and inspection method shall be agreed by both parties according to GB/T 11334					
Surface roughness	Taper: grinding Ra=0.8μm; Cutting or cold heading Ra=3.2μm; end face Ra=6.3μm					
Surface defects	No irregular and harmful defects are allowed, and no burr is allowed in any part of the pin					
surface treatment	Type standard	oxidation				
		QC/T 625				
Acceptance and packaging	GB/T 90.1, GB/T 903.2					

JX-DIN 258-2012 Taper pin with screw tail

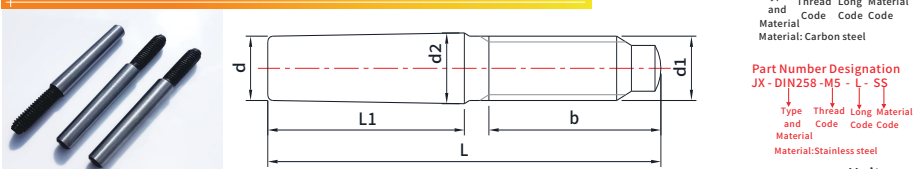

Part Number Designation
JX-DIN258 - M5 - L - ST
 Type and Material Code: Carbon steel
 Thread Code: M5
 Long Code: L
 Material Code: ST

Part Number Designation
JX-DIN258 - M5 - L - SS
 Type and Material Code: Stainless steel
 Thread Code: M5
 Long Code: L
 Material Code: SS

Size	P/N		d		b		L1			
	Carbon Steel	Stainless Steel	max	min	max	min	nom	max	min	
M5	JX-DIN258-M5-5.25-L-ST	JX-DIN258-M5-5.25-L-SS	5	4.952	15.6	14	M5	5.5	25	24.8
M6	JX-DIN258-M6-6.6-30-L-ST	JX-DIN258-M6-6.6-30-L-SS	6	5.952	20	18	M6	6.6	30	29.8
M8	JX-DIN258-M8-8.8-40-L-ST	JX-DIN258-M8-8.8-40-L-SS	8	7.942	24.5	22	M8	8.8	40	39.7
M10	JX-DIN258-M10-10.9-45-L-ST	JX-DIN258-M10-10.9-45-L-SS	10	9.942	27	24	M10	10.9	45	44.7
M12	JX-DIN258-M12-13.1-55-L-ST	JX-DIN258-M12-13.1-55-L-SS	12	11.93	30.5	27	M12	13.1	55	54.7
M12	JX-DIN258-M12-15.3-65-L-ST	JX-DIN258-M12-15.3-65-L-SS	14	13.93	33.5	30	M12	15.3	65	64.7
M16	JX-DIN258-M16-15.3-65-L-ST	JX-DIN258-M16-15.3-65-L-SS	16	15.93	39	35	M16	17.4	72	71.7
M16	JX-DIN258-M16-21.7-85-L-ST	JX-DIN258-M16-21.7-85-L-SS	20	19.916	39	35	M16	21.7	85	84.7
M20	JX-DIN258-M20-27-100-L-ST	JX-DIN258-M20-27-100-L-SS	25	24.916	45	40	M20	27	100	99.7
M24	JX-DIN258-M24-32.2-110-L-ST	JX-DIN258-M24-32.2-110-L-SS	30	29.916	52	46	M24	32.2	110	109.7
M30	JX-DIN258-M30-42.6-130-L-ST	JX-DIN258-M30-42.6-130-L-SS	40	39.9	65	58	M30	42.6	130	129.5
M36	JX-DIN258-M36-53-150-L-ST	JX-DIN258-M36-53-150-L-SS	50	49.9	78	70	M36	53	150	149.5

JX-GB/T 877 Taper pin with split end

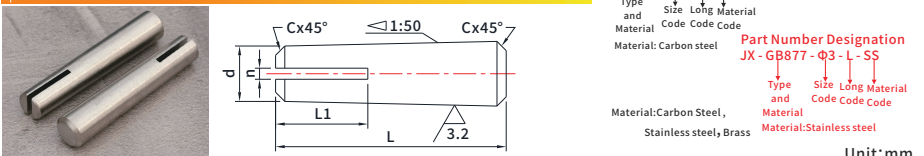

Part Number Designation
JX-GB877 - Φ3 - L - ST
 Type and Material Code: Carbon steel
 Size Code: Φ3
 Long Code: L
 Material Code: ST

Part Number Designation
JX-GB877 - Φ3 - L - SS
 Type and Material Code: Stainless steel
 Size Code: Φ3
 Long Code: L
 Material Code: SS

Size	P/N			d		n			L1
	Carbon Steel	Stainless Steel	Brass	min	max	nom	min	max	
Φ3	JX-GB877-Φ3-3-10-L-ST	JX-GB877-Φ3-3-10-L-SS	JX-GB877-Φ3-3-10-L-B	2.96	3	0.8	0.86	1	10
Φ4	JX-GB877-Φ4-4-10-L-ST	JX-GB877-Φ4-4-10-L-SS	JX-GB877-Φ4-4-10-L-B	3.952	4	0.8	0.86	1	10
Φ5	JX-GB877-Φ5-5-12-L-ST	JX-GB877-Φ5-5-12-L-SS	JX-GB877-Φ5-5-12-L-B	4.952	5	1	1.06	1.2	12
Φ6	JX-GB877-Φ6-6-15-L-ST	JX-GB877-Φ6-6-15-L-SS	JX-GB877-Φ6-6-15-L-B	5.952	6	1	1.06	1.2	15
Φ8	JX-GB877-Φ8-8-20-L-ST	JX-GB877-Φ8-8-20-L-SS	JX-GB877-Φ8-8-20-L-B	7.942	8	1.6	1.66	1.91	20
Φ10	JX-GB877-Φ10-10-25-L-ST	JX-GB877-Φ10-10-25-L-SS	JX-GB877-Φ10-10-25-L-B	9.942	10	1.6	1.66	1.91	25
Φ12	JX-GB877-Φ12-12-30-L-ST	JX-GB877-Φ12-12-30-L-SS	JX-GB877-Φ12-12-30-L-B	11.93	12	2	2.06	2.31	30
Φ16	JX-GB877-Φ16-16-40-L-ST	JX-GB877-Φ16-16-40-L-SS	JX-GB877-Φ16-16-40-L-B	15.93	16	2	2.06	2.31	40

Remark: 1. We can also manufacture according to other materials and specifications required by customers.
 2. Surface treatment: Color Zinc, ROHS Blue White Zinc, Black, Yellow zinc, white zinc, H. D. G., Dakeuo, Zinc, Nickel, Bronze, Copper, Phosphate, Oxidation black, Tin, Gold, Chrome, Silver, Zinc-nickel alloy plated etc.

Remark: 1. We can also manufacture according to other materials and specifications required by customers.
 2. Surface treatment: Color Zinc, ROHS Blue White Zinc, Black, Yellow zinc, white zinc, H. D. G., Dakeuo, Zinc, Nickel, Bronze, Copper, Phosphate, Oxidation black, Tin, Gold, Chrome, Silver, Zinc-nickel alloy plated etc.