

SCREWS FASTENERS SERIES

QJ 2383-1992 Slotted Large Raised Cheese Head Screws

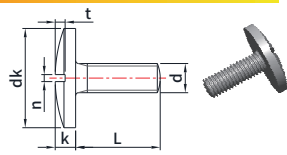

Part Number Designation
JX-QJ2383-M2-10-ST
Type and Material: Carbon Steel
Size and Code: M2
Long Material Code: 10
Material Code: ST

Part Number Designation
JX-QJ2383-M2-10-SS
Type and Material: Stainless Steel
Size and Code: M2
Long Material Code: 10
Material Code: SS

Material: Carbon Steel, Stainless Steel, Brass, Aluminum, Titanium
Surface treatment: ROHS zinc, nickel, zinc-nickel alloy, Chromium, dacromet, copper

Unit:mm

Size	P/N			dk	Min	k	Min	Nom	Max	n	t
	Carbon Steel	Stainless Steel	Brass								
M1.6	JX-QJ383-M1.6-L-ST	JX-QJ383-M1.6-L-SS	JX-QJ383-M1.6-L-B	6	5.82	1.2	1.06	0.4	0.6	0.46	0.6
M2	JX-QJ383-M2-L-ST	JX-QJ383-M2-L-SS	JX-QJ383-M2-L-B	7	6.78	1.4	1.26	0.5	0.7	0.56	0.7
M2.5	JX-QJ383-M2.5-L-ST	JX-QJ383-M2.5-L-SS	JX-QJ383-M2.5-L-B	9	8.78	1.8	1.66	0.6	0.8	0.66	0.9
M3	JX-QJ383-M3-L-ST	JX-QJ383-M3-L-SS	JX-QJ383-M3-L-B	11	10.73	2	1.86	0.8	1	0.86	1
M4	JX-QJ383-M4-L-ST	JX-QJ383-M4-L-SS	JX-QJ383-M4-L-B	14	13.73	2.8	2.66	1.2	1.51	1.26	1.4
M5	JX-QJ383-M5-L-ST	JX-QJ383-M5-L-SS	JX-QJ383-M5-L-B	17	16.73	3.5	3.32	1.2	1.51	1.26	1.7

ANSI/ASME B 18.21-2012 Hexagon head screw

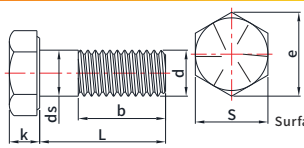

Part Number Designation
JX-ANSI18.21-M2-10-ST
Type and Material: Carbon Steel
Size and Code: M2
Long Material Code: 10
Material Code: ST

Part Number Designation
JX-ANSI18.21-M2-10-SS
Type and Material: Stainless Steel
Size and Code: M2
Long Material Code: 10
Material Code: SS

Material: Carbon Steel, Stainless Steel, Brass, Aluminum, Titanium
Surface treatment: ROHS zinc, nickel, zinc-nickel alloy, Chromium, dacromet, copper

Unit:inch

Size	料号P/N		ds		S		k		b	
	Carbon Steel	Stainless Steel	max.	min.	max.	min.	max.	min.	L≤6	L>6
1/4	JX-ANSI18.21-1/4-L-ST	JX-ANSI18.21-1/4-L-SS	0.25	0.245	0.438	0.428	0.163	0.15	0.75	1
5/16	JX-ANSI18.21-5/16-L-ST	JX-ANSI18.21-5/16-L-SS	0.3125	0.3065	0.5	0.489	0.211	0.195	0.875	1.125
3/8	JX-ANSI18.21-3/8-L-ST	JX-ANSI18.21-3/8-L-SS	0.375	0.369	0.562	0.551	0.243	0.226	1	1.25
7/16	JX-ANSI18.21-7/16-L-ST	JX-ANSI18.21-7/16-L-SS	0.4375	0.4305	0.625	0.612	0.291	0.272	1.125	1.375
1/2	JX-ANSI18.21-1/2-L-ST	JX-ANSI18.21-1/2-L-SS	0.5	0.493	0.75	0.736	0.323	0.302	1.25	1.5
9/16	JX-ANSI18.21-9/16-L-ST	JX-ANSI18.21-9/16-L-SS	0.5625	0.5545	0.812	0.798	0.371	0.348	1.375	1.625
5/8	JX-ANSI18.21-5/8-L-ST	JX-ANSI18.21-5/8-L-SS	0.625	0.617	0.938	0.922	0.403	0.378	1.5	1.75
3/4	JX-ANSI18.21-3/4-L-ST	JX-ANSI18.21-3/4-L-SS	0.75	0.741	1.125	1.1	0.483	0.455	1.75	2
7/8	JX-ANSI18.21-7/8-L-ST	JX-ANSI18.21-7/8-L-SS	0.875	0.866	1.312	1.285	0.563	0.531	2	2.25
1	JX-ANSI18.21-1-L-ST	JX-ANSI18.21-1-L-SS	1	0.99	1.5	1.469	0.627	0.591	2.25	2.5
1-1/8	JX-ANSI18.21-1-1/8-L-ST	JX-ANSI18.21-1-1/8-L-SS	1.125	1.114	1.688	1.631	0.718	0.658	2.5	2.75

GB/T 29.1-2013 Hexagon Bolts With Slot On Head

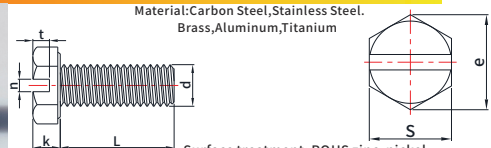

Part Number Designation
JX-GB29-M3-L-ST
Type and Material: Carbon Steel
Size and Code: M3
Long Material Code: L
Material Code: ST

Part Number Designation
JX-GB29-M3-L-SS
Type and Material: Stainless Steel
Size and Code: M3
Long Material Code: L
Material Code: SS

Material: Carbon Steel, Stainless Steel, Brass, Aluminum, Titanium
Surface treatment: ROHS zinc, nickel, zinc-nickel alloy, Chromium, dacromet, copper

Unit:mm

Size	P/N			Pitch	n			
	Carbon Steel	Stainless Steel	Brass		nom.	min.	max.	min.
M3	JX-GB29-M3-L-ST	JX-GB29-M3-L-SS	JX-GB29-M3-L-B	0.5	0.8	0.86	1	0.7
M4	JX-GB29-M4-L-ST	JX-GB29-M4-L-SS	JX-GB29-M4-L-B	0.7	1.2	1.26	1.51	1
M5	JX-GB29-M5-L-ST	JX-GB29-M5-L-SS	JX-GB29-M5-L-B	0.8	1.2	1.28	1.51	1.2
M6	JX-GB29-M6-L-ST	JX-GB29-M6-L-SS	JX-GB29-M6-L-B	1	1.6	1.66	1.91	1.4
M8	JX-GB29-M8-L-ST	JX-GB29-M8-L-SS	JX-GB29-M8-L-B	1.25	2	2.06	2.31	1.9
M10	JX-GB29-M10-L-ST	JX-GB29-M10-L-SS	JX-GB29-M10-L-B	1.5	2.5	2.56	2.81	2.4
M12	JX-GB29-M12-L-ST	JX-GB29-M12-L-SS	JX-GB29-M12-L-B	1.75	3	3.06	3.31	3

①. Other form dimensions shall be in accordance with GB/T 5783

SCREW FASTENERS SERIES

ANSI/ASME 18.6.3-2013 Slotted hexagon bolt with gasket

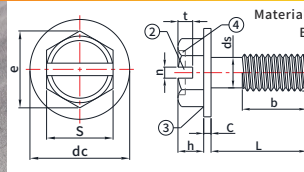

Material: Carbon Steel, Stainless Steel, Brass, Aluminum, Titanium
Surface treatment: ROHS zinc, nickel, zinc-nickel alloy, Chromium, dacromet, copper

Part Number Designation
JX-ANSI18/6.3-2#-L-ST
Type and Material: Carbon Steel
Size and Code: 2#
Long Material Code: L
Material Code: ST

Part Number Designation
JX-ANSI18/6.3-2#-L-SS
Type and Material: Stainless Steel
Size and Code: 2#
Long Material Code: L
Material Code: SS

Unit:inch

Size	P/N		d	UNC	S		e	h	dc		C		n		t	
	Carbon Steel	Stainless Steel			min.	max.			min.	max.	min.	max.	min.	max.	min.	max.
2#	JX-ANSI18.6.3-2#-L-ST	JX-ANSI18.6.3-2#-L-SS	0.0860	56	0.125	0.120	0.134	0.050	0.040	0.166	0.154	0.016	0.010	-	-	-
3#	JX-ANSI18.6.3-3#-L-ST	JX-ANSI18.6.3-3#-L-SS	0.0990	48	0.125	0.120	0.134	0.055	0.044	0.177	0.163	0.016	0.010	-	-	-
4#	JX-ANSI18.6.3-4#-L-ST	JX-ANSI18.6.3-4#-L-SS	0.1120	40	0.188	0.181	0.202	0.060	0.049	0.243	0.225	0.019	0.011	0.039	0.031	0.042
5#	JX-ANSI18.6.3-5#-L-ST	JX-ANSI18.6.3-5#-L-SS	0.1250	40	0.188	0.181	0.202	0.070	0.058	0.260	0.240	0.025	0.015	0.043	0.035	0.049
6#	JX-ANSI18.6.3-6#-L-ST	JX-ANSI18.6.3-6#-L-SS	0.1380	32	0.250	0.244	0.272	0.093	0.080	0.328	0.302	0.025	0.015	0.048	0.039	0.053
7#	JX-ANSI18.6.3-7#-L-ST	JX-ANSI18.6.3-7#-L-SS	0.1510	-	0.250	0.244	0.272	0.093	0.080	0.328	0.302	0.025	0.017	0.048	0.039	0.053
8#	JX-ANSI18.6.3-8#-L-ST	JX-ANSI18.6.3-8#-L-SS	0.1640	32	0.250	0.244	0.272	0.110	0.096	0.348	0.322	0.031	0.019	0.054	0.045	0.074
10#	JX-ANSI18.6.3-10#-L-ST	JX-ANSI18.6.3-10#-L-SS	0.1900	24	0.312	0.305	0.340	0.120	0.105	0.414	0.384	0.031	0.019	0.060	0.050	0.080
12#	JX-ANSI18.6.3-12#-L-ST	JX-ANSI18.6.3-12#-L-SS	0.2160	24	0.312	0.305	0.340	0.155	0.139	0.432	0.398	0.039	0.022	0.067	0.056	0.103
14#	JX-ANSI18.6.3-14#-L-ST	JX-ANSI18.6.3-14#-L-SS	0.2420	-	0.375	0.367	0.409	0.190	0.172	0.520	0.480	0.050	0.030	0.075	0.064	0.111
1/4	JX-ANSI18.6.3-1/4#-L-ST	JX-ANSI18.6.3-1/4#-L-SS	0.2500	20	0.375	0.367	0.409	0.190	0.172	0.520	0.480	0.050	0.030	0.075	0.064	0.111

GB/T 14-2013 Mushroom Head Square Neck Bolts

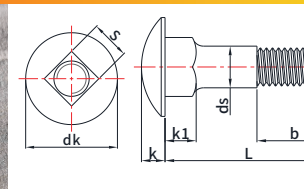

Material: Carbon Steel, Stainless Steel, Brass, Aluminum, Titanium
Surface treatment: ROHS zinc, nickel, zinc-nickel alloy, Chromium, dacromet, copper

Part Number Designation
JX-GB14-M5-L-ST
Type and Material: Carbon Steel
Size and Code: M5
Long Material Code: L
Material Code: ST

Part Number Designation
JX-GB14-M5-L-SS
Type and Material: Stainless Steel
Size and Code: M5
Long Material Code: L
Material Code: SS

Unit:mm

Size	P/N		Pitch	b		dk		ds		k1		k		S	
	Carbon Steel	Stainless Steel		L≤125	125<L≤200	L>200	max.	min.	max.	min.	max.	min.	max.	min.	max.
M5	JX-GB14-M5-L-ST	JX-GB14-M5-L-SS	0.8	16	-	-	13	11.9	5.48	4.1	2.9	3.1	2.5	5.48	4.52
M6	JX-GB14-M6-L-ST	JX-GB14-M6-L-SS	1	18	-	-	16	14.9	6.48	4.6	3.4	3.6	3	6.48	5.52
M8	JX-GB14-M8-L-ST	JX-GB14-M8-L-SS	1.25	22	28	-	20	18.7	8.58	5.6	4.4	4.6	4	8.58	7.42
M10	JX-GB14-M10-L-ST	JX-GB14-M10-L-SS	1.5	26	32	-	24	22.7	10.58	6.6	5.4	5.8	5	10.58	9.42
M12	JX-GB14-M12-L-ST	JX-GB14-M12-L-SS	1.75	30	36	-	30	28.7	12.7	8.8	7.2	6.8	6	12.7	11.3
M16	JX-GB14-M16-L-ST	JX-GB14-M16-L-SS	2	38	44	57	38	36.4	16.7	12.9	11.1	8.9	8	16.7	15.3
M20	JX-GB14-M20-L-ST	JX-GB14-M20-L-SS	2.5	46	52	65	46	44.4	20.84	15.9	14.1	10.9	10	20.84	19.16

ANSI/ASME B 18.5-2012 Flat countersunk head elevator bolts

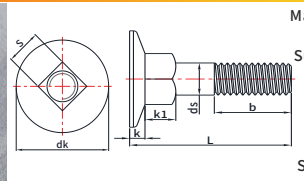

Material: Carbon Steel, Stainless Steel, Brass, Aluminum, Titanium
Surface treatment: ROHS zinc, nickel, zinc-nickel alloy, Chromium, dacromet, copper

Part Number Designation
JX-ANSI18.5-#10-L-ST
Type and Material: Carbon Steel
Size and Code: #10
Long Material Code: L
Material Code: ST

Part Number Designation
JX-ANSI18.5-#10-L-SS
Type and Material: Stainless Steel
Size and Code: #10
Long Material Code: L
Material Code: SS

Standard: ASME B 18.5 - 2012 2017

Unit:inch

Size	P/N		ds		dk		k		S		k1	
	Carbon Steel	Stainless Steel	max.	min.	max.	min.	max.	min.	max.	min.	max.	min.
#10	JX-ANSI18.5-#10-L-ST	JX-ANSI18.5-#10-L-SS	0.199	0.182	0.79	0.75	0.082	0.062	0.21	0.185	0.125	0.094
1/4	JX-ANSI18.5-1/4-L-ST	JX-ANSI18.5-1/4-L-SS	0.26	0.237	1.008	0.969	0.098	0.078	0.28	0.245	0.219	0.188
5/16	JX-ANSI18.5-5/16-L-ST	JX-ANSI18.5-5/16-L-SS	0.324	0.298	1.277	1.188	0.114	0.094	0.342	0.307	0.25	0.219
3/8	JX-ANSI18.5-3/8-L-ST	JX-ANSI18.5-3/8-L-SS	0.388	0.36	1.352	1.312	0.145	0.125	0.405	0.368	0.25	0.219
7/16	JX-ANSI18.5-7/16-L-ST	JX-ANSI18.5-7/16-L-SS	0.452	0.421	1.477	1.438	0.176	0.156	0.468	0.431	0.281	0.25
1/2	JX-ANSI18.5-1/2-L-ST	JX-ANSI18.5-1/2-L-SS	0.515	0.483	1.602	1.562	0.176	0.156	0.53	0.492	0.281	0.25