

AUTOMOTIVE SCREWS FASTENERS SERIES

Hexagon socket head cap screws-thin type



Material: Carbon Steel, Stainless Steel, Brass, Aluminum, Titanium
 Surface treatment: ROHS zinc, nickel, zinc-nickel alloy, dacromet
 Standard: JB / ZQ 4725 - 2006
 JIS B 1176 - 2006

Part Number Designation
 JX-STSH-M2-6-ST
 Type and Code Thread Long Material Code Code Code
 Material: Carbon Steel

Part Number Designation
 JX-SSTSH-M2-6-SS
 Type and Code Thread Long Material Code Code Code
 Material: Stainless Steel

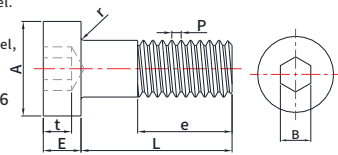

Carbon steel Grade: 4.8, 5.8, 8.8, 10.9, 12.9 Unit: mm

Size	P/N		P	A	E	B	t max.	L										r	
	Carbon steel	Stainless steel																	
M2	JX-STSH-M2-L-ST	JX-SSTSH-M2-L-SS	0.4	3.8	1.3	1.3	1	4	5	6									0.1 or more
M2.5	JX-STSH-M2.5-L-ST	JX-SSTSH-M2.5-L-SS	0.45	4.5	1.6	1.5	1.3	4	5	6	8	10							0.1 or more
M3	JX-STSH-M3-L-ST	JX-SSTSH-M3-L-SS	0.5	5.5	2	2	1.5	4	5	6	8	10	12	16	20				0.1 or more
M4	JX-STSH-M4-L-ST	JX-SSTSH-M4-L-SS	0.7	7	2.8	2.5	2.3	5	6	8	10	12	16	20	25				0.2 or more
M5	JX-STSH-M5-L-ST	JX-SSTSH-M5-L-SS	0.8	8.5	3.5	3	2.7	5	6	8	10	12	16	20	25	30			0.2 or more
M6	JX-STSH-M6-L-ST	JX-SSTSH-M6-L-SS	1.0	10	4	4	3	8	10	12	16	20	25	30	35	40	45		0.25 or more
M8	JX-STSH-M8-L-ST	JX-SSTSH-M8-L-SS	1.25	13	5	5	3.8	10	12	16	20	25	30	35	40	45	50		0.4 or more
M10	JX-STSH-M10-L-ST	JX-SSTSH-M10-L-SS	1.5	16	6	6	4.5	16	20	25	30	35	40						0.4 or more
M12	JX-STSH-M12-L-ST	JX-SSTSH-M12-L-SS	1.75	18	7	8	5	20	30										0.6 or more

Hexagon Socket Flat Head Screw



Material: Carbon steel
 Grade: 4.8, 5.8, 8.8, 10.9, 12.9
 Material: Stainless steel
 Surface treatment: Zinc, Chromium, Zinc nickel alloy

Part Number Designation
 JX-US-M2-6-ST
 Type and Code Thread Long Finish Code Code Code
 Material: Carbon Steel

Part Number Designation
 JX-US-M2-6-SS
 Type and Code Thread Long Material Code Code Code
 Material: Stainless Steel

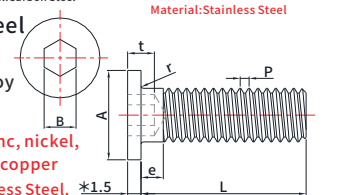

Surface treatment: ROHS zinc, nickel, zinc-nickel alloy, dacromet, copper
 Material: Carbon Steel, Stainless Steel, Brass, Aluminum, Titanium
 Unit: mm

Size	P/N		P	A	B	t max.	e max.	L										r (JX-STSU)		
	Carbon steel	Stainless steel																		
M2	JX-US-M2-L-ST	JX-US-M2-L-SS	0.4	4	1.3	1.2	1.2	3	4	5	6	8	10	12						-
M2.5	JX-US-M2.5-L-ST	JX-US-M2.5-L-SS	0.45	5	1.3	1.5	1.5	4	5	6	8	10	12							0.1~
M3	JX-US-M3-L-ST	JX-US-M3-L-SS	0.5	6	1.5	2	1.6	4	5	6	8	10	12							0.2~
M4	JX-US-M4-L-ST	JX-US-M4-L-SS	0.7	8	2	2.5	1.6	5	6	8	10	12	14	16	20					0.2~
M5	JX-US-M5-L-ST	JX-US-M5-L-SS	0.8	9	3	3	2	6	8	10	12	14	16	18	20	25				0.25~
M6	JX-US-M6-L-ST	JX-US-M6-L-SS	1.0	10	3	4	2.5	6	8	10	12	14	16	18	20	25	30			0.25~
M8	JX-US-M8-L-ST	JX-US-M8-L-SS	1.25	13	4	5	3	10	12	14	16	18	20	25	30					0.4~
M10	JX-US-M10-L-ST	JX-US-M10-L-SS	1.5	16(15)	5	5	3.5	16	20	25	30									0.4~

Ultra short hexagon bolt



Carbon Steel Grade: 4.8, 5.8, 8.8, 10.9, 12.9
 Material: Carbon Steel, Stainless Steel, Brass, Aluminum, Titanium
 Surface treatment: ROHS zinc, nickel, zinc-nickel alloy, Chromium, dacromet, copper

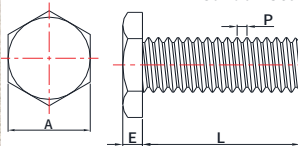

Remark: Material and surface treatment can also be manufactured according to customer requirements

AUTOMOTIVE SCREWS FASTENERS SERIES

Part Number Designation
 JX-TH-M4-8-ST
 Type and Code Thread Long Material Code Code Code
 Material: Carbon Steel

Material: Carbon Steel, Stainless Steel, Brass, Aluminum, Titanium
 Surface treatment: ROHS zinc, nickel, zinc-nickel alloy, Chromium, dacromet, copper

Part Number Designation
 JX-TH-M4-8-SS
 Type and Code Thread Long Material Code Code Code
 Material: Stainless Steel

Size	P/N		P	A	E	L														
	Carbon steel	Stainless steel																		
M4	JX-TH-M4-L-ST	JX-TH-M4-L-SS	0.7	7	1.5	8	10	12	15	20	25	30								
M5	JX-TH-M5-L-ST	JX-TH-M5-L-SS	0.8	8	2.0	8	10	12	15	20	25	30								
M6	JX-TH-M6-L-ST	JX-TH-M6-L-SS	1.0	10		8	10	12	15	20	25	30								

Hexagon Socket Head Cap Screws With Low Head With Reduced Loadability

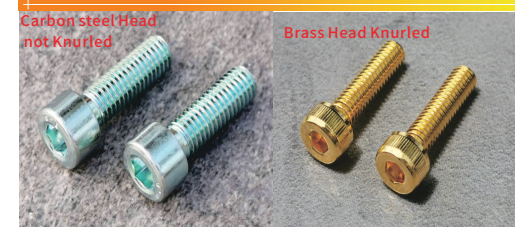

Carbon steel Head not Knurled

Brass Head Knurled

Part Number Designation
 JX-TDS-M3-6-ST
 Type and Code Thread Long Material Code Code Code
 Material: Carbon Steel

Part Number Designation
 JX-TDS-M3-6-SS
 Type and Code Thread Long Material Code Code Code
 Material: Stainless Steel

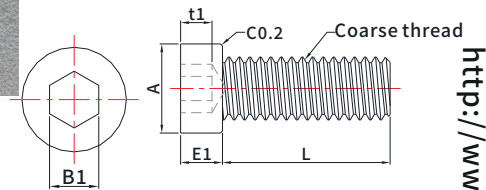

Material: Carbon Steel, Stainless Steel, Brass, Aluminum, Titanium
 Carbon Steel Grade: 4.8, 5.8, 8.8, 10.9, 12.9
 Surface treatment: ROHS zinc, nickel, zinc-nickel alloy, Chromium, dacromet, copper

Standard: DIN 7984 - 2021 Unit: mm

Size	P/N				A	E1	B1	t1	L											
	Carbon steel	Stainless steel	Titanium	Brass																
M3	JX-TDS-M3-L-ST	JX-TDS-M3-L-SS	JX-TDS-M3-L-Ti	JX-TDS-M3-L-B	4.5	2	2	(1.5)	5	6	8	10	-	-	-	-	-	-	-	-
M4	JX-TDS-M4-L-ST	JX-TDS-M4-L-SS	JX-TDS-M4-L-Ti	JX-TDS-M4-L-B	5.5	2.8	2.5	(2)	6	8	10	12	16	20						
M5	JX-TDS-M5-L-ST	JX-TDS-M5-L-SS	JX-TDS-M5-L-Ti	JX-TDS-M5-L-B	7	3.5	3	(2.5)	8	10	12	16	20	-	-	-	-	-	-	-
M6	JX-TDS-M6-L-ST	JX-TDS-M6-L-SS	JX-TDS-M6-L-Ti	JX-TDS-M6-L-B	8.5	4	4	(3)	8	10	12	16	20	-	-	-	-	-	-	-

小径螺栓 Small diameter bolt



Titanium Head not Knurled

Stainless Steel Head Knurled

Part Number Designation
 JX-SDB-M3-6-ST
 Type and Code Thread Long Material Code Code Code
 Material: Carbon Steel

Part Number Designation
 JX-SDB-M3-6-SS
 Type and Code Thread Long Material Code Code Code
 Material: Stainless Steel

Material: Carbon Steel, Stainless Steel, Brass, Aluminum, Titanium
 Surface treatment: ROHS zinc, nickel, zinc-nickel alloy, Chromium, dacromet, copper

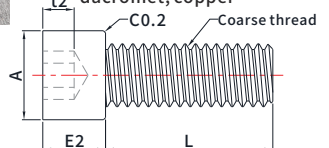

Material: Carbon steel
 Carbon Steel Grade: 4.8, 5.8, 8.8, 10.9, 12.9
 Material: Stainless steel
 Titanium, aluminum, Brass

Unit: mm

Size	P/N				A	E2	B2	t2	L											
	Carbon steel	Stainless steel	Titanium	Brass																
M3	JX-SDB-M3-L-ST	JX-SDB-M3-L-SS	JX-SDB-M3-L-Ti	JX-SDB-M3-L-B	4.5	3	2.5	(1.5)	5	6	8	10	-	-	-	-	-	-	-	-
M4	JX-SDB-M4-L-ST	JX-SDB-M4-L-SS	JX-SDB-M4-L-Ti	JX-SDB-M4-L-B	5.5	4	3	(2)	6	8	10	12	16	20						
M5	JX-SDB-M5-L-ST	JX-SDB-M5-L-SS	JX-SDB-M5-L-Ti	JX-SDB-M5-L-B	7	5	4	(2.5)	8	10	12	16	20	-	-	-	-	-	-	-
M6	JX-SDB-M6-L-ST	JX-SDB-M6-L-SS	JX-SDB-M6-L-Ti	JX-SDB-M6-L-B	8.5	6	5	(3)	8	10	12	16	20	-	-	-	-	-	-	-

Remark: Material and surface treatment can also be manufactured according to customer requirements