

# JX HARDWARE FASTENERS NUTS SERIES

## 1.5d JX-DIN 6331-2003 Hexagon nut with medium thickness

Material: Carbon steel  
Stainless steel



Surface treatment: zinc, zinc - nickel alloy  
Can also be produced according to customer requirements

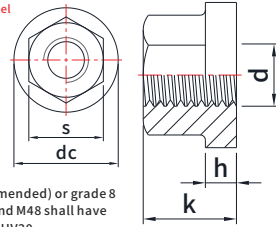

①. Nuts of sizes M6 to M36 shall be made of Grade 10 (recommended) or grade 8 steel in accordance with DIN EN 20898-2. Nuts of sizes M42 and M48 shall have a hardness of (240 + 62) HV30 (recommended) or (188 + 114) HV30.

Unit:mm

Size	P/N		P	h (js14)		dc (h13)		k (js15)		s (h13/h14)		Weight of 1000pcs ≈Kg		
	Carbon Steel	Stainless Steel		nom.	max.	nom.	min.	nom.	max.	nom.	min.			
M6	JX-D6331-M6-ST	JX-D6331-M6-SS	1	3	3.125	2.875	14	13.73	9	9.29	8.71	10	9.78	6
M8	JX-D6331-M8-ST	JX-D6331-M8-SS	1.25	3.5	3.65	3.35	18	17.73	12	12.35	11.65	13	12.73	12
M10	JX-D6331-M10-ST	JX-D6331-M10-SS	1.5	4	4.15	3.85	22	21.67	15	15.35	14.65	16	15.73	22
M12	JX-D6331-M12-ST	JX-D6331-M12-SS	1.75	4	4.15	3.85	25	24.67	18	18.35	17.65	18	17.73	30
M16	JX-D6331-M16-ST	JX-D6331-M16-SS	2	5	5.15	4.85	31	30.61	24	24.42	23.65	24	23.67	68
M20	JX-D6331-M20-ST	JX-D6331-M20-SS	2.5	6	6.15	5.85	37	36.61	30	30.42	29.58	30	29.67	124
M24	JX-D6331-M24-ST	JX-D6331-M24-SS	3	6	6.15	5.85	45	44.61	36	36.5	35.5	36	35.38	219
M27	JX-D6331-M27-ST	JX-D6331-M27-SS	3	7	7.18	6.82	50	49.61	40	40.5	39.5	41	40.38	320
M30	JX-D6331-M30-ST	JX-D6331-M30-SS	3.5	8	8.18	7.82	58	57.54	45	45.5	44.5	46	45.38	464
M36	JX-D6331-M36-ST	JX-D6331-M36-SS	4	10	10.18	9.82	68	67.54	54	54.6	53.4	55	54.26	790
M42	JX-D6331-M42-ST	JX-D6331-M42-SS	4.5	12	12.215	11.785	80	79.54	63	63.6	62.4	65	64.26	1290
M48	JX-D6331-M48-ST	JX-D6331-M48-SS	5	14	14.215	13.785	92	91.46	72	72.6	71.4	75	74.26	1970

## JX-JB/ZQ 6545-2007 All gold spring band hexagon lock nut

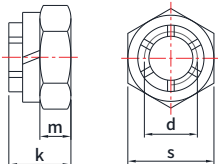
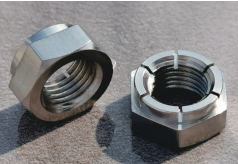

Material: Carbon steel  
Stainless steel, Brass

Surface treatment: zinc, zinc - nickel alloy  
Can also be produced according to customer requirements

Unit:mm

Size	P/N		k		m		S		
	Carbon steel	Stainless steel	max.	min.	max.	min.	max.	min.	
M8	JX-JB/ZQ6545-M8-ST	JX-JB/ZQ6545-M8-SS	JX-JB/ZQ6545-M8-B	JX-JB/ZQ6545-M8-AL	9	8.14	4.5	13	12.73
M10	JX-JB/ZQ6545-M10-ST	JX-JB/ZQ6545-M10-SS	JX-JB/ZQ6545-M10-B	JX-JB/ZQ6545-M10-AL	11	9.94	5.5	16	15.73
M12	JX-JB/ZQ6545-M12-ST	JX-JB/ZQ6545-M12-SS	JX-JB/ZQ6545-M12-B	JX-JB/ZQ6545-M12-AL	13	12.57	6.6	18	17.73
M14	JX-JB/ZQ6545-M14-ST	JX-JB/ZQ6545-M14-SS	JX-JB/ZQ6545-M14-B	JX-JB/ZQ6545-M14-AL	14.1	13.4	7.7	21	20.67
M16	JX-JB/ZQ6545-M16-ST	JX-JB/ZQ6545-M16-SS	JX-JB/ZQ6545-M16-B	JX-JB/ZQ6545-M16-AL	16.4	15.7	8.8	24	23.67
M18	JX-JB/ZQ6545-M18-ST	JX-JB/ZQ6545-M18-SS	JX-JB/ZQ6545-M18-B	JX-JB/ZQ6545-M18-AL	18	17.3	9.2	27	26.16
M20	JX-JB/ZQ6545-M20-ST	JX-JB/ZQ6545-M20-SS	JX-JB/ZQ6545-M20-B	JX-JB/ZQ6545-M20-AL	20.3	19	11	30	29.16
M22	JX-JB/ZQ6545-M22-ST	JX-JB/ZQ6545-M22-SS	JX-JB/ZQ6545-M22-B	JX-JB/ZQ6545-M22-AL	22	20.7	12.1	34	33
M24	JX-JB/ZQ6545-M24-ST	JX-JB/ZQ6545-M24-SS	JX-JB/ZQ6545-M24-B	JX-JB/ZQ6545-M24-AL	23.9	22.6	13.2	36	35
M27	JX-JB/ZQ6545-M27-ST	JX-JB/ZQ6545-M27-SS	JX-JB/ZQ6545-M27-B	JX-JB/ZQ6545-M27-AL	27	25.7	13.7	41	40
M30	JX-JB/ZQ6545-M30-ST	JX-JB/ZQ6545-M30-SS	JX-JB/ZQ6545-M30-B	JX-JB/ZQ6545-M30-AL	30	27.3	16.5	46	45
M33	JX-JB/ZQ6545-M33-ST	JX-JB/ZQ6545-M33-SS	JX-JB/ZQ6545-M33-B	JX-JB/ZQ6545-M33-AL	33	31.7	19	50	49
M36	JX-JB/ZQ6545-M36-ST	JX-JB/ZQ6545-M36-SS	JX-JB/ZQ6545-M36-B	JX-JB/ZQ6545-M36-AL	36	33.1	19.8	55	53.8
M39	JX-JB/ZQ6545-M39-ST	JX-JB/ZQ6545-M39-SS	JX-JB/ZQ6545-M39-B	JX-JB/ZQ6545-M39-AL	39	37.4	22	60	58.8
M42	JX-JB/ZQ6545-M42-ST	JX-JB/ZQ6545-M42-SS	JX-JB/ZQ6545-M42-B	JX-JB/ZQ6545-M42-AL	42	39	25	65	63.8
M48	JX-JB/ZQ6545-M48-ST	JX-JB/ZQ6545-M48-SS	JX-JB/ZQ6545-M48-B	JX-JB/ZQ6545-M48-AL	48	45	27	75	73.1

## JX-TB/T 777-2005 Slotted hexagon nuts

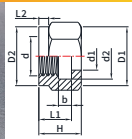

Unit:mm

Material: Carbon Steel, Stainless steel, Brass

- When DN3-DN8, D1=D2≈0.9s; when dn10-DN50, D1=D2≈0.95s
- It is applicable to the steel joint nut with the service temperature of -40°C ~ 200°C and the nominal pressure less than or equal to 4.0Mpa on the rolling stock.
- The outer surface of the parts shall have clear and durable marks. The sign content consists of two parts: nominal diameter and manufacturer's mark, with 3 or 5 characters.

# JX HARDWARE FASTENERS NUTS SERIES

Size	P/N		DN	P Pitch	d1		d2	e	L1	L2	H	S		b	weight ≈kg
	Carbon Steel	Stainless Steel			max.	min.						max.	min.		
M12	JX-TB/T777-M12-ST	JX-TB/T777-M12-SS	3	1.5	8.52	8.3	12.5	20.8	10	3	13	18	17.57	4	0.018
M18	JX-TB/T777-M18-ST	JX-TB/T777-M18-SS	6	1.5	13.57	13.3	18.5	27.7	15	3	18	24	23.57	6	0.032
M20	JX-TB/T777-M20-ST	JX-TB/T777-M20-SS	8	1.5	15.63	15.3	20.5	31.1	15	3	18	27	26.48	6	0.033
M24	JX-TB/T777-M24-ST	JX-TB/T777-M24-SS	10	2	18.83	18.5	24.5	34.6	15	3	18	30	29.48	6	0.045
M27	JX-TB/T777-M27-ST	JX-TB/T777-M27-SS	10	2	21.83	21.5	27.5	39.2	15	3	18	34	33	6	0.07
M27	JX-TB/T777-M27-ST	JX-TB/T777-M27-SS	13	2	21.83	21.5	27.5	39.2	15	5	18	34	33	6	0.07
M32	JX-TB/T777-M32-ST	JX-TB/T777-M32-SS	15	2	26.83	26.5	33.5	47.3	17	5	20	41	40	8	0.128
M36	JX-TB/T777-M36-ST	JX-TB/T777-M36-SS	20	2	31.99	31.6	36.5	53.1	17	5	20	46	45	8	0.1
M45	JX-TB/T777-M45-ST	JX-TB/T777-M45-SS	25	2	39.89	39.5	45.5	63.6	20	5	23	5	54	8	0.193
M45	JX-TB/T777-M45-ST	JX-TB/T777-M45-SS	25	2	39.89	39.5	45.5	63.6	20	5	23	5	53.8	8	0.144
M48	JX-TB/T777-M48-ST	JX-TB/T777-M48-SS	32	2	43.89	43.5	48.5	63.6	22	5	26	5	53.8	8	0.156

## GJB 134.1-1986 Shear type high lock nut

Material: Carbon steel,  
Stainless steel  
Aluminum, Brass

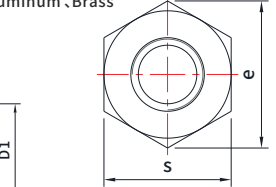
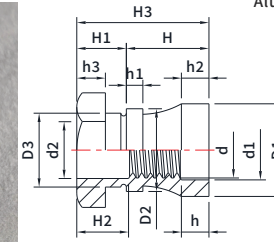

Carbon steel P/N: JX-GJB134.1-M5-ST  
Stainless steel P/N: JX-GJB134.1-M5-SS  
Aluminum P/N: JX-GJB134.1-M5-AL  
Brass P/N: JX-GJB134.1-M5-B

Unit:mm

Size	M5	M6	M8	M10		
料号 P/N	JX-GJB134.1-M5-ST	JX-GJB134.1-M6-ST	JX-GJB134.1-M8-ST	JX-GJB134.1-M10-ST		
P	Pitch	0.8	1	1.25		
d1	H11	nom.	5.4	6.4	8.4	10.4
		max.	5.475	6.49	8.49	10.51
d2		nom.	5.15	6.15	8.15	10.2
		max.	5.2	6.2	8.2	10.25
e		10	11.2	15.8	19.2	
s			9	10	14	17
			8.4	10	14	17
D1	h11	nom.	8.31	9.91	13.89	16.89
		min.	7.5	9	12	15
D2	After closing size	nom.	7.442	8.942	11.93	14.93
		nom.	7	8.46	11.46	14.44
		max.	7.06	8.52	11.52	14.5
		min.	6.94	8.4	11.4	14.38
D3			6.7	7.5	10	12.5
			7.5	8.5	11	12.5
H		nom.	7.7	8.7	11.2	12.7
		max.	7.3	8.3	10.8	12.3
		min.	4.5	5	6	7
H1		nom.	4.3	4.8	5.8	6.8
		max.	4.6	5.1	6.1	7.1
H2		nom.	4.8	5.3	6.3	7.3
		max.	12	13.5	17	19.5
H3	Reference	nom.	2.5	2.6	3	3.2
		max.	2.75	2.85	3.25	3.45
h		nom.	1.5	1.8	2.2	2.5
		max.	1.65	1.95	2.35	2.65
h1		nom.	1.35	1.65	2.05	2.35
		max.	2.5	2.6	3	3
h2		nom.	2.75	2.85	3.25	3.25
		max.	0.49-0.98	0.88-1.47	2.25-3.43	2.74-4.41
Locking moment		1.96-2.94	4.15-6.08	12.25-15.68	19.6-25.48	
Breaking torque		Before installation	1.05	1.37	3.52	5.75
		After installation	0.56	0.86	2.13	3.63
Weight of 1000pcs ≈Kg						