

HARDWARE NUTS FASTENERS SERIES

Locking nut JX-YCF Series

Material: 42CrMo
Hardness: HRC28°~32°
Thread accuracy: ISO 4H
Plane deflection: 0.002-0.005mm

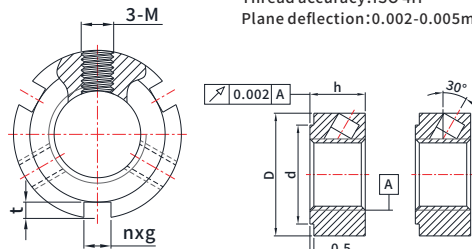

JX-YCF type locking nut is designed with locking copper and thread at an angle of 30° and does not bear the axial load acting on the thread. When the nut is locked, the thread surface will not release the axial load and the nut will not deform.
Three equal distance locking copper can be used to adjust the deviation of other parts to be installed on the shaft. Because the locking copper will not deform, the F-type nut can still maintain the precision after repeated disassembly and assembly

Unit:mm

Size	P/N	D	h	d	nxg	t	M	Max. Nm
M12x1	JX-YCF-M12X1	29	14	25	3x5	3	M8	4.5
M12x1.25	JX-YCF-M12X1.25	29	14	25	3x5	3	M8	4.5
M14x1.5	JX-YCF-M14X1.5	31	14	25	3x5	3	M8	4.5
M14x1	JX-YCF-M14X1	31	14	25	3x5	3	M8	4.5
M15x1	JX-YCF-M15X1	31	14	28	3x5	3	M8	4.5
M16x1.5	JX-YCF-M16X1.5	32	14	25	3x5	3	M8	4.5
M16x1	JX-YCF-M16X1	32	14	25	3x5	3	M8	4.5
M17x1.5	JX-YCF-M17X1.5	34	16	28	3x5	3	M8	8
M17x1	JX-YCF-M17X1	34	16	28	3x5	3	M8	8
M18x1.5	JX-YCF-M18X1.5	34	16	28	3x5	3	M8	8
M20x1	JX-YCF-M20X1	38	16	32	3x5	3	M8	8
M20x1.5	JX-YCF-M20X1.5	38	16	32	3x5	3	M8	8
M22x1.5	JX-YCF-M22X1.5	38	16	32	3x5	3	M8	8

JX-DN Square Locking Nuts

Material: DIN C45
Surface treatment: Sandblasting and black Quenching and tempering hardness: HRC24°~28°
Thread accuracy: ISO 4H Precision turning
Plane deflection: 0.002~0.005mm
Screw grade: Level 12.9
Locking metal: Phosphor bronze

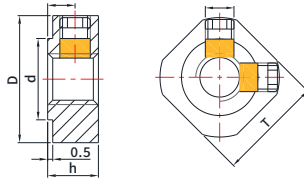

The shape of JX-DN type square lock nut is square, its fixing copper is fixed radially, the internal thread and the end face are processed at the same time, which can ensure the accuracy of assembly. It can avoid the need of locking gasket and keyway. This square nut is mainly used for screw rod support seat.

Unit:mm

Size	P/N	P	D	h	d	L	T	n-M	Screw tightening torque Nm	Maximum axial load KN	Weight Kg
M5	JX-DN-M5*0.5	0.5	13.5	5	10	2.7	12	1-M3x0.5	0.9	15	0.002
M6	JX-DN-M6*0.75	0.75	14.5	5	10	2.7	12	1-M3x0.5	0.9	17	0.004
M8	JX-DN-M8*0.75	0.75	17	6.5	13	4	14	1-M3x0.5	0.9	23	0.008
M8	JX-DN-M8*1.0	1	17	6.5	13	4	14	1-M3x0.5	0.9	23	0.008
M10	JX-DN-M10*0.75	0.75	20	8	15	5	17	2-M4x0.7	3.5	31	0.012
M10	JX-DN-M10*1.0	1	20	8	15	5	17	2-M4x0.7	3.5	31	0.012
M12	JX-DN-M12*1.0	1	22	8	17	5	19	2-M4x0.7	3.5	38	0.014
M15	JX-DN-M15*1.0	1	25	8	21	4.5	22	2-M4x0.7	3.5	50	0.016
M17	JX-DN-M17*1.0	1	30	13	25	9	24	2-M4x0.7	3.5	57	0.034
M20	JX-DN-M20*1.0	1	35	11	26	7	30	2-M4x0.7	3.5	69	0.042
M25	JX-DN-M25*1.5	1.5	43	15	33	10	35	2-M5x0.8	4.5	90	0.052
M30	JX-DN-M30*1.5	1.5	48	20	39	14	40	2-m5x1	8	112	0.074
M35	JX-DN-M35*1.5	1.5	60	21	46	14	50	2-M8x1.25	18	134	1.1
M40	JX-DN-M40*1.5	1.5	63	25	51	18	50	2-M8x1.25	18	176	0.134

Remark: We only show part of the specifications, we can also produce various sizes according to the customer's requirements

HARDWARE NUTS FASTENERS SERIES

GB/T 802.5-2009 Non metallic insert hexagon lock cap nut welding type

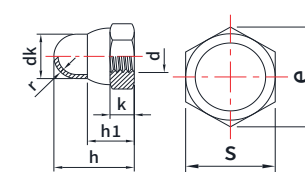

Material: Carbon steel, Stainless steel

Surface treatment: zinc, nickel, zinc-nickel alloy, dacromet, etc. surface treatment can also be done according to customer requirements

Unit:mm

Size	P/N		P	dk max.	e	h1			h		k	s		r	Weight of 1000pcs ≈ kg			
	Carbon Steel	Stainless Steel				Thread Size	nom.	max.	min.	max.		min.	max.			min.		
M4	JX-GB802.5-M4-ST	JX-GB802.5-M4-SS	0.7	/	/	6.5	7.66	5.6	5.85	5.35	9.6	9.9	9.3	2.9	7	6.78	0.5	1.4
M5	JX-GB802.5-M5-ST	JX-GB802.5-M5-SS	0.8	/	/	7.5	8.79	6	6.25	5.75	10.5	10.85	10.15	4.4	8	7.78	0.5	1.55
M6	JX-GB802.5-M6-ST	JX-GB802.5-M6-SS	1	/	/	9.5	11.05	7.5	7.85	7.15	12	12.35	11.65	4.9	10	9.78	0.8	3.3
M8	JX-GB802.5-M8-ST	JX-GB802.5-M8-SS	1.25	1	/	12.5	14.38	8.9	9.25	8.55	14	14.35	13.65	6.44	13	12.73	0.8	5.3
M10	JX-GB802.5-M10-ST	JX-GB802.5-M10-SS	1.5	1	1.25	16	17.77	10.5	10.9	10.1	18.1	18.5	17.7	8.04	16	15.73	0.8	10.1
M12	JX-GB802.5-M12-ST	JX-GB802.5-M12-SS	1.75	1.5	1.25	18	20.03	13.5	13.9	13.1	22.5	22.9	22.1	10.37	18	17.73	1	18.3
M13	JX-GB802.5-M13-ST	JX-GB802.5-M13-SS	2	1.5	/	21	23.35	15.5	15.9	15.1	26.4	26.8	26	12.1	21	20.67	1	26.1
M16	JX-GB802.5-M16-ST	JX-GB802.5-M16-SS	2	1.5	/	23	26.75	16.5	16.9	16.1	27.5	27.9	27.1	14.1	24	23.67	1	37.1
M20	JX-GB802.5-M20-ST	JX-GB802.5-M20-SS	2.5	2	1.5	28	32.95	21	21.5	20.5	35	35.5	34.5	16.9	30	29.16	1.2	111

JX-Q394B, JX-Q395B, JX-Q395C Acorn nuts - Assembling type

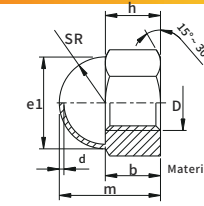

Standard: Q394B Q395B Q395C (GB/T 802-1988)
Part Number Designation JX-Q394B/Q395B/Q395C-M8-ST
Type and Material: Material: Steel
Thread Code
Material Code
Part Number Designation JX-Q394B/Q395B/Q395C-M8-SS
Type and Material: Material: Stainless Steel
Thread Code
Material Code

Unit:mm

Size	P/N			e1	b	m min	h	d	SR	s		
	Q394B	Q395B	Q395C							max	min	
M5	/	/	JX-Q394B-M5-ST	JX-Q394B-M5-SS	7.2	4	9	5.5	0.5	3.6	8	7.78
M6	/	/	JX-Q394B-M6-ST	JX-Q394B-M6-SS	9.2	5	11	6.5	0.8	4.6	10	9.78
M8	M8X1	/	JX-Q394B/Q395B-M8-ST	JX-Q394B/Q395B-M8-SS	13	6	15	8	0.8	6.5	13	12.73
M10	M10X1	(M10X1.25)	JX-Q394B/Q395B/Q395C-M10-ST	JX-Q394B/Q395B/Q395C-M10-SS	16	8	18	10	0.8	8	16	15.73
M12	(M12X1.25)	M12X1.5	JX-Q394B/Q395B/Q395C-M12-ST	JX-Q394B/Q395B/Q395C-M12-SS	18	10	22	12	1	9	18	17.73
(M14)	(M14X1.5)	/	JX-Q394B/Q395B-M14-ST	JX-Q394B/Q395B-M14-SS	20	11	24	13	1	10	21	20.67
M16	M16X1.5	/	JX-Q394B/Q395B-M16-ST	JX-Q394B/Q395B-M16-SS	22	13	26	15	1	11.5	24	23.67
(M18)	(M18X1.5)	/	JX-Q394B/Q395B-M18-ST	JX-Q394B/Q395B-M18-SS	25	14	30	17	1.2	12.5	27	26.16
M20	(M20X1.5)	M20X2	JX-Q394B/Q395B/Q395C-M20-ST	JX-Q394B/Q395B/Q395C-M20-SS	28	16	35	19	1.2	14	30	29.16

JX-DIN314 Square wing butterfly nut

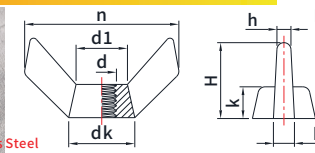

Material: Carbon steel, Stainless steel, Brass

Unit:mm

Size	P/N			Pitch	n			h	d1			dk	k		
	Carbon steel	Stainless Steel	Brass		max.	min.	max.		max.	min.	max.			min.	
M4	JX-DIN314-M4-ST	JX-DIN314-M4-SS	JX-DIN314-M4-B	0.7	21	19	11	9	1.1	7	5.5	9	7	4.6	3.2
M5	JX-DIN314-M5-ST	JX-DIN314-M5-SS	JX-DIN314-M5-B	0.8	26.5	24.5	13	11	1.5	9	7.5	12	9	6	4
M6	JX-DIN314-M6-ST	JX-DIN314-M6-SS	JX-DIN314-M6-B	1	32	29	16	14	1.5	11	9	14	11	7	5
M8	JX-DIN314-M8-ST	JX-DIN314-M8-SS	JX-DIN314-M8-B	1.25	38	35	19	17	2	12.5	10.5	16	13	8.5	6.5
M10	JX-DIN314-M10-ST	JX-DIN314-M10-SS	JX-DIN314-M10-B	1.5	50	47	24	22	3.6	16	14	21	18	10	8
M12	JX-DIN314-M12-ST	JX-DIN314-M12-SS	JX-DIN314-M12-B	1.75	66	63	32	29	4.1	19	17	24	21	13	10