

BLIND RIVETS SERIES

Mono-Anlock Type Rivets

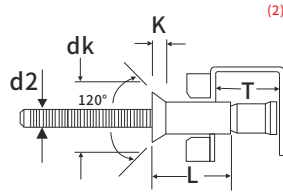

(1) Material: Aluminum Body+Aluminum Mandrel
Countersunk Head

(2) Material: Steel Body+Steel Mandrel
Countersunk Head

(3) Material: Stainless Steel Body+Stainless
Steel Mandrel
Countersunk Head

Unit:mm

Size	Grip Range	P/N									Hole Size	L Max.	dk Max.	K Max.	T Min.	d2 Max.
		Aluminum CSK Head			Steel CSK Head			Stainless Steel CSK Head								
		Mono Lock	Shear N	Tensile N	Mono Lock	Shear N	Tensile N	Mono Lock	Shear N	Tensile N						
4.8 (3/16)	3.2-8.4	JX-CH4.8-12-AL-M	2400	2000	JX-CH4.8-12-ST-M	5800	4100	JX-CH4.8-12-SS-M	5800	4100	4.9-5.1	12	8.5	2.2	10.5	3.1
	3.2-12.2	JX-CH4.8-16-AL-M			JX-CH4.8-16-ST-M			JX-CH4.8-16-SS-M			4.9-5.1	16	8.5	2.2	13.5	
6.4 (1/4")	3.2-12.1	JX-CH6.4-16-AL-M	5600	3700	JX-CH6.4-16-ST-M	10500	8200	JX-CH6.4-16-SS-M	10500	8200	6.6-7.0	16	10.1	2.4	12.2	4.1
	3.2-16.0	JX-CH6.4-22-AL-M			JX-CH6.4-22-ST-M			JX-CH6.4-22-SS-M			6.6-7.0	22	10.1	2.4	16.4	

Self Plugger Steel blind rivets

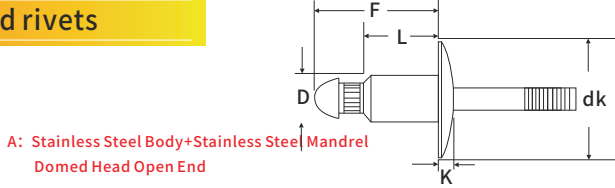
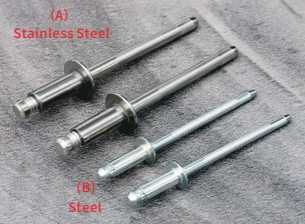

A: Stainless Steel Body+Stainless Steel Mandrel
Domed Head Open End

B: Material:Steel Body+Steel Mandrel
Domed Head Open End

Unit:Inch/mm

Size	L	F	Grip Range	Part NO		Hole Size	D	K	Dk	Shear Strength lbs N	Tensile Strength lbs N
				Stainless Steel (A)	Steel (B)						
1/8 (3.2)	.250 (6.4)	.452 (11.5)	.063-.125 (1.6-3.1)	JX-SSD 42 SP.093	JX-SD 42 SP.093	.129-.133 (3.3-3.40)	.122-.128 (3.10-3.25)	.031-.041 (0.79-1.05)	.238-.262 (6.09-6.71)	450 (2001)	350 (1556)
	.329 (8.4)	.528 (13.4)	.150-.195 (3.8-4.9)	JX-SSD 43 SP.163	JX-SD 43 SP.163						
	.391 (10.0)	.590 (15.0)	.185-.240 (4.6-5.0)	JX-SSD 44 SP.185	JX-SD 44 SP.185						
	.507 (12.9)	.706 (17.9)	.312-.360 (7.9-9.1)	JX-SSD 46 SP.312	JX-SD 46 SP.312						
5/32 (4.0)	.437 (11.1)	.669 (17.0)	.205-.260 (5.2-6.6)	JX-SSD 55 SP.218	JX-SD 55 SP.218	.160-.164 (4.06-4.17)	.152-.158 (3.89-4.04)	.040-.050 (1.03-1.28)	.296-.326 (7.59-8.41)	525 (2335)	500 (2224)
	.562 (14.3)	.794 (20.2)	.241-.368 (6.1-9.3)	JX-SSD 56 SP.241	JX-SD 56 SP.241						
	.315 (8.0)	.612 (15.8)	.062-.125 (1.5-3.1)	JX-SSD 62 SP.093	JX-SD 62 SP.093						
3/16 (4.8)	.378 (9.6)	.668 (17.0)	.065-.187 (1.6-4.7)	JX-SSD 63 SP.130	JX-SD 63 SP.130	.192-.196 (4.88-4.98)	.183-.191 (4.71-4.860)	.045-.058 (1.14-1.48)	.355-.393 (9.09-10.06)	900 (4005)	700 (3113)
	.425 (10.8)	.693 (17.6)	.126-.250 (3.2-6.4)	JX-SSD 64 SP.187	JX-SD 64 SP.187						
	.440 (11.2)	.702 (17.8)	.181-.272 (4.6-6.9)	JX-SSD 64 SP.220	JX-SD 64 SP.220						
	.700 (17.7)	.950 (24.1)	.376-.500 (9.6-12.7)	JX-SSD 64 SP.437	JX-SD 64 SP.437						
	.365 (9.3)	.650 (16.5)	.376-.500 (9.6-12.7)	JX-SSD 68 SP.437	JX-SD 68 SP.437						
1/4 (6.4)					.257-.261 (6.53-6.63)	.249-.255 (6.37-6.53)	.066-.076 (1.69-1.95)	.475-.525 (12.16-13.33)	1750 (7788)	1400 (6227)	

BLIND RIVETS SERIES

Lockbolt blind rivets

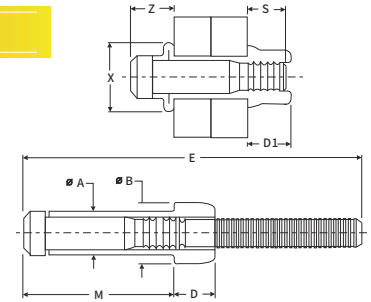

(1) Material: Aluminum Body+Steel Mandrel
Dome Head

Unit:mm

Size	Grip Range	P/N	Hole Size	ΦA Max.	ΦB Max.	D Max.	D1 Max.	E Min.	M Max.	S Max.	X Nom.	Z Max.	Tensile Strength KN	Shear Strength KN
4.8 (3/16)	2.36-3.99	JX-LR-4.8-12.41	5.28-5.64	5.20	7.32	4.95	5.26	37.11	12.41	6.38	7.54	5.35	12.40	8.00
	3.99-5.59	JX-LR-4.8-14.01	5.28-5.64	5.20	7.32	4.95	5.26	38.69	14.01					
	5.59-7.16	JX-LR-4.8-15.59	5.28-5.64	5.20	7.32	4.95	5.26	40.27	15.59					
	7.16-8.76	JX-LR-4.8-17.19	5.28-5.64	5.20	7.32	4.95	5.26	41.84	17.19					
	8.76-10.34	JX-LR-4.8-18.76	5.28-5.64	5.20	7.32	4.95	5.26	43.41	18.76					
	10.34-11.94	JX-LR-4.8-20.36	5.28-5.64	5.20	7.32	4.95	5.26	44.99	20.36					
	11.94-13.51	JX-LR-4.8-21.94	5.28-5.64	5.20	7.32	4.95	5.26	46.56	21.94					
	13.51-15.11	JX-LR-4.8-23.54	5.28-5.64	5.20	7.32	4.95	5.26	48.14	23.54					
	15.11-16.69	JX-LR-4.8-25.11	5.28-5.64	5.20	7.32	4.95	5.26	49.71	25.11					
	16.69-18.29	JX-LR-4.8-26.71	5.28-5.64	5.20	7.32	4.95	5.26	51.29	26.71					
6.4 (1/4")	2.36-3.99	JX-LR-6.4-16.51	7.04-7.42	6.78	9.70	6.61	7.88	45.87	16.51	8.76	9.65	7.24	22.69	14.46
	3.99-5.59	JX-LR-6.4-18.11	7.04-7.42	6.78	9.70	6.61	7.88	47.32	18.11					
	5.59-7.16	JX-LR-6.4-19.69	7.04-7.42	6.78	9.70	6.61	7.88	48.89	19.69					
	7.16-8.76	JX-LR-6.4-21.29	7.04-7.42	6.78	9.70	6.61	7.88	50.47	21.29					
	8.76-10.34	JX-LR-6.4-22.86	7.04-7.42	6.78	9.70	6.61	7.88	52.04	22.86					
	10.34-11.94	JX-LR-6.4-24.46	7.04-7.42	6.78	9.70	6.61	7.88	53.62	24.46					
	11.94-13.51	JX-LR-6.4-26.04	7.04-7.42	6.78	9.70	6.61	7.88	55.19	26.04					
	13.51-15.11	JX-LR-6.4-27.64	7.04-7.42	6.78	9.70	6.61	7.88	56.77	27.64					
	15.11-16.69	JX-LR-6.4-29.21	7.04-7.42	6.78	9.70	6.61	7.88	58.34	29.21					
	16.69-18.29	JX-LR-6.4-30.81	7.04-7.42	6.78	9.70	6.61	7.88	59.92	30.81					
8.0 (5/16)	4.78-7.95	JX-LR-8-23.31	8.84-9.35	8.76	12.39	8.61	9.20	62.42	23.31	10.25	12.28	9.10	36.47	23.57
	7.95-11.13	JX-LR-8-26.49	8.84-9.35	8.76	12.39	8.61	9.20	65.57	26.49					
	11.13-14.30	JX-LR-8-29.66	8.84-9.35	8.76	12.39	8.61	9.20	68.72	29.66					
	14.30-17.48	JX-LR-8-32.84	8.84-9.35	8.76	12.39	8.61	9.20	71.87	32.84					
	17.48-20.65	JX-LR-8-36.01	8.84-9.35	8.76	12.39	8.61	9.20	75.02	36.01					
	20.65-23.83	JX-LR-8-39.19	8.84-9.35	8.76	12.39	8.61	9.20	78.17	39.19					
	23.83-26.97	JX-LR-8-42.36	8.84-9.35	8.76	12.39	8.61	9.20	81.32	42.36					