

# BLIND RIVET SERIES

## Close End Domed Head Steel Blind Rivets

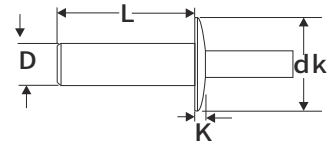

A: Material: Steel Body + Steel Mandrel  
Domed Head Close End

B: Material: Brass Body + Steel Mandrel  
Domed Head Close End

Unit: Inch/mm

Size	L	Grip Range	Part NO	Hole Size	D	K	dk	Shear Strength lbs N	Tensile Strength lbs N
1/8 (3.2)	.277 (7.0)	.062-.187 (1.6-4.8)	JX-SD 46 SB	.129-.133 (3.3-3.38)	.122-.129 (3.10-3.28)	.039 (1.0)	.240-.259 (6.12-6.58)	259 (1150)	270 (1200)
5/32 (4.0)	.41 (8.7)	.062-.187 (1.6-4.8)	JX-SD 56 SB	.160-.164 (4.06-4.17)	.151-.160 (3.85-4.08)	.047 (1.2)	.2300-.323 (7.62-8.22)	389 (1730)	418 (1860)
3/16 (4.8)	.466 (11.8)	.0-.125 (0-3.2)	JX-SD 64 SB	.192-.196 (4.88-4.98)	.183-.192 (4.65-4.88)	.051 (1.3)	.363-.387 (9.23-9.83)	545 (2425)	638 (2840)
			JX-SD 68 SB						

## Structural Blind Rivets

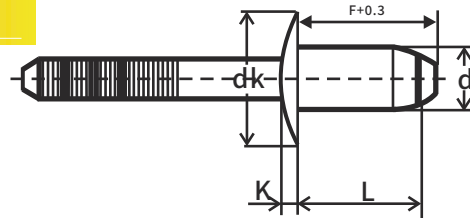

Material: Body Steel + Mandrel Steel

Material: Body Aluminum + Mandrel Carbon Steel

Material: Body Stainless Steel + Mandrel Stainless Steel

Unit: mm

Size	L	P/N			Grip Range	Hole Size	F ±0.3	L			dk	K	Shear Strength KN		Tensile Strength KN	
		Steel	Aluminum	Stainless Steel				Nom	Min	Max			Max	Max	Steel	Aluminum
4.8 (3/16")	9	JX-HG4.8-9-ST	JX-HG4.8-9-AI	JX-HG4.8-9-SS	2.0-3.5	4.9-5.2	11.5	9	8.7	9.3	9.7	1.7	3.6	1.55	3.8	2.25
		JX-HG4.8-11-ST	JX-HG4.8-11-AI	JX-HG4.8-11-SS	2.5-3.5	4.9-5.2	13.5	11	10.7	11.3	9.7	1.7	3.65	1.6		
		JX-HG4.8-12-ST	JX-HG4.8-12-AI	JX-HG4.8-12-SS	4.5-5.5	4.9-5.2	14.5	12	11.7	12.3	9.7	1.7	3.7	1.8		
		JX-HG4.8-14-ST	JX-HG4.8-14-AI	JX-HG4.8-14-SS	5.5-6.5	4.9-5.2	16.5	14	13.7	14.3	9.7	1.7	3.75	2.0		
6.4 (1/4")	12	JX-HG6.4-12-ST	JX-HG6.4-12-AI	JX-HG6.4-12-SS	1.5-3.5	6.7-6.9	14.5	12	13.7	14.69	13.4	3.4	10.5	5.0	8.8	2.67
		JX-HG6.4-13-ST	JX-HG6.4-13-AI	JX-HG6.4-13-SS	2.8-3.8	6.7-6.9	15.5	13	15.0	15.99			12.0	6.0		
	JX-HG6.4-14-ST	JX-HG6.4-14-AI	JX-HG6.4-14-SS	3.35-5.35	6.7-6.9	16.5	14	15.6	16.59	12.5			6.2			
	JX-HG6.4-15-ST	JX-HG6.4-15-AI	JX-HG6.4-15-SS	4.8-6.80	6.7-6.9	17.5	15	17.0	17.99	12.5			6.5	7.0		
	JX-HG6.4-17-ST	JX-HG6.4-17-AI	JX-HG6.4-17-SS	6.8-8.80	6.7-6.9	19.5	17	19.0	19.99	15.0			7.0			
	JX-HG6.4-18-ST	JX-HG6.4-18-AI	JX-HG6.4-18-SS	7.50-9.50	6.7-6.9	20.5	18	19.7	20.69	16.0			7.0			
	JX-HG6.4-19-ST	JX-HG6.4-19-AI	JX-HG6.4-19-SS	8.80-10.8	6.7-6.9	21.5	19	21.0	21.99	16.0			7.0			
	JX-HG6.4-21-ST	JX-HG6.4-21-AI	JX-HG6.4-21-SS	10.8-12.8	6.7-6.9	23.5	21	23.0	23.99	16.0			7.0			

# BLIND RIVET SERIES

## Single Grip Stainless Steel Blind Rivets

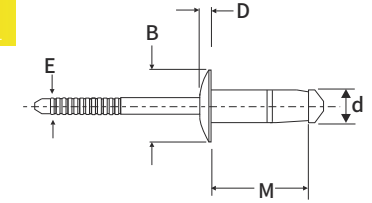

Material: Stainless Steel Body + Stainless Steel Mandrel  
Domed Head Single Grip

Unit: mm

Size d	Grip Range	P/N	Hole Size	M Max	ΦB Max	D Max	E Max	Shear Strength KN	Tensile Strength KN
3.2 (1/8")	1.0-3.0	JX-D3.2-9-SGSS	3.3-3.4	9.0	6.15-6.45	1.1	2.1	2.0	1.6
	3.0-5.0	JX-D3.2-11.5-SGSS	3.3-3.4	11.5					
	5.0-7.0	JX-D3.2-14.1-SGSS	3.3-3.4	14.1					
4.0 (5/32")	1.0-3.0	JX-D4-10.3-SGSS	4.1-4.3	10.3	7.5-8.0	1.5	2.6	5.2	4.0
	3.0-5.0	JX-D4-12.9-SGSS	4.1-4.3	12.9					
4.8 (3/16)	5.0-7.0	JX-D4-15.6-SGSS	4.1-4.3	15.6	9.15-9.6	1.5	3.1	5.5	5.0
	1.5-3.5	JX-D4.8-12.8-SGSS	4.9-5.1	12.8					
	3.5-6.0	JX-D4.8-15.4-SGSS	4.9-5.1	15.4					
6.4 (1/4")	6.0-8.5	JX-D4.8-18.4-SGSS	4.9-5.1	18.4	12.8-13.4	3.1	4.87	10.7	10.2
	1.5-5.5	JX-D6.4-17.1-SGSS	6.6-7.0	17.1					
	5.0-9.0	JX-D6.4-20.1-SGSS	6.6-7.0	20.1					

## Single Grip Steel Blind Rivets

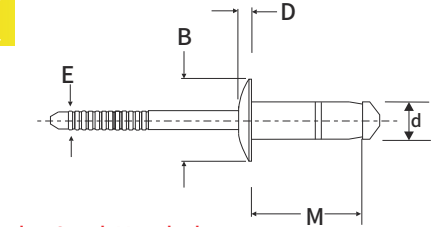

Material: Steel Body + Steel Mandrel  
Domed Head Single Grip

Unit: mm

Size d	Grip Range	P/N	Hole Size	M Max	ΦB Max	D Max	E Max	Shear Strength KN	Tensile Strength KN
3.2 (1/8")	1.0-3.0	JX-D3.2S-9.1-SGST	3.3-3.4	9.1	6.8	1.4	2.1	1.2	2.0
	3.0-5.0	JX-D3.2-11.7-SGST	3.3-3.4	11.7				1.7	
	5.0-7.0	JX-D3.2-14.1-SGST	3.3-3.4	14.1				2.5	
4.0 (5/32")	1.0-3.0	JX-D4-10.4-SGST	4.1-4.3	10.4	8.0	1.4	2.6	2.4	2.8
	3.0-5.0	JX-D4-12.9-SGST	4.1-4.3	12.9				3.5	
	5.0-7.0	JX-D4-15.7-SGST	4.1-4.3	15.7				4.1	
	7.0-9.0	JX-D4.8-18.1-SGST	4.1-4.3	18.1				3.3	
4.8 (3/16)	1.5-3.5	JX-D4.8-12.1-SGST	4.9-5.1	12.1	9.6	1.5	3.2	3.6	3.8
	3.5-6.0	JX-D4.8-14.7-SGST	4.9-5.1	14.7				4.2	
	6.0-8.5	JX-D6.4-17.6-SGST	4.9-5.1	17.6				5.6	
6.4 (1/4")	1.5-5.5	JX-D6.4-16.8-SGST	6.6-7.0	16.8	13.4	3.1	4.87	10.0	7.6
	5.0-9.0	JX-D6.4-20.8-SGST	6.6-7.0	20.8				7.6	