

BLIND RIVET SERIES

Multi-Grip blind rivet



(A)Material:Steel Body+Steel Mandrel
Domed Head Multi Grip

(B)Material:Steel Body+Steel Mandrel
Domed Head Multi Grip Lage Flange

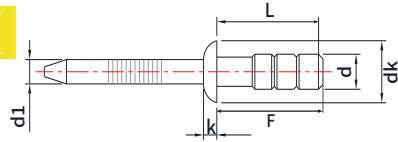

Unit :Inch/mm

Size	L	F	Grip Range	Part NO	Hole Size	D	d1	K	dk	Shear Strength lbs N	Tensile Strength lbs N
1/8 (3.2)	.334 (8.5)	.512 (13.0)	.059-.197 (1.5-5.0)	JX-MG21-03208-210	.130-.134 (3.3-3.4)	.120-.129 (3.05-3.28)	2.1	.031-.047 (0.8-1.2)	.228-.260 (5.8-6.6)	270 (1200)	360 (1500)
	.492 (12.5)	.669 (17.0)	.157-.315 (4.0-8.0)	JX-MG21-03208-210-B							
	.413 (10.5)	.591 (15.0)	.059-.256 (1.5-6.5)	JX-MG21-04010-210							
5/32 (4.0)	.649 (16.5)	.827 (21.0)	.157-.472 (4.0-12.0)	JX-MG21-04016-210	.161-.165 (4.1-4.2)	.152-.160 (3.85-4.08)	2.6	.039-.055 (1.0-1.4)	.291-.327 (7.4-8.3)	370 (1650)	540 (2400)
	.413 (10.5)	.610 (15.5)	.059-.236 (1.5-6.0)	JX-MG21-04810-210							
	.649 (16.5)	.846 (21.5)	.157-.433 (4.0-11.0)	JX-MG21-04816-210							
3/16 (4.8)	.649 (16.5)	.846 (21.5)	.157-.433 (4.0-11.0)	JX-MG21-04816-210	.193-.197 (4.9-5.0)	.183-.192 (4.65-4.88)	3.1	.047-.063 (1.2-1.6)	.254-.36 (6.4-9.1)	607 (2700)	719 (3200)
	.070 (1.8)	.086 (2.2)	.006-.045 (0.15-1.1)	JX-MG21-04816-210-B							
	.070 (1.8)	.086 (2.2)	.006-.045 (0.15-1.1)	JX-MG21-04816-210-B							
6.4)1/4	16.8	22.8	6.4-10	JX-MG21-064168-210	6.53-6.63	6.4	4.0	1.6	16.1	5538N	6694N

Load Spreading rivets

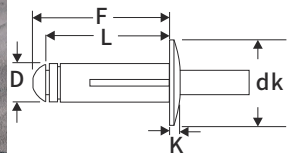

Material:Aluminum Body+Aluminum Mandrel
Domed Head Load Spreading

Remark:For epdm rubber pad, with acid - resistant, heat resistant ability

Unit :Inch/mm

Size	L	F	Grip Range	Part NO	Hole Size	D	K	dk	Shear Strength lbs N	Tensile Strength lbs N
1/8(3.2)	.664 (16.9)	.755 (19.2)	0-.250 (0-6.4)	JX-ACD 408 ASM	.129-.133 (3.28-3.38)	.123-.129 (3.15-3.28)	.031-.047 (0.78-1.00)	.236-.260 (6.05-6.65)	124 (550)	202 (900)
	.689 (17.5)	.780 (19.8)	0-.250 (0-6.4)	JX-ACD 508 ASM						
5/32 (4.0)	.838 (21.3)	.909 (23.6)	.118-.375 (3.0-9.5)	JX-ACD 512 ASM	.165-.169 (4.19-4.3)	.154-.163 (3.94-4.18)	.045-.053 (1.14-1.34)	.291-.325 (7.6-8.25)	220 (900)	292 (1300)
	.984 (25.0)	1.071 (27.2)	.197-.472 (5.0-12.0)	JX-ACD 516 ASM						
	.689 (17.5)	.800 (20.3)	0-.250 (0-6.4)	JX-ACD 608 ASM						
3/16 (4.8)	.795 (19.8)	.890 (22.6)	.118-.375 (3.0-9.5)	JX-ACD 612 ASM	.197-.205 (5.0-5.2)	.184-.194 (4.7-4.97)	.054-.062 (1.37-1.57)	.363-.378 (9.23-9.83)	225 (1000)	312 (1400)
	.925 (23.5)	1.040 (26.4)	.197-.472 (5.0-12.0)	JX-ACD 616 ASM						
	.175 (4.4)	.205 (5.2)	0.5-4.8 (1.3-12.2)	JX-ACD52-17.5						
5.2	19.1	22.1	1.5-6.4 (3.8-16.3)	JX-ACD52-19.1	5.3-5.5	5.1-5.29	2.2	10.9-11.7	2700	1950
	22.2	25.2	4.8-9.5 (12.2-24.1)	JX-ACD52-22.2						
	25.4	28.2	7.9-12.7 (20.0-32.3)	JX-ACD52-25.4						
	28.6	31.6	11.1-15.9 (28.1-40.3)	JX-ACD52-28.6						
	31.8	34.8	14.3-19.1 (36.3-48.4)	JX-ACD52-31.8						
	20.2	23.2	1.6-6.4 (4.1-16.3)	JX-ACD63-20.2						
6.3	23.4	26.4	3.2-9.5 (8.1-24.1)	JX-ACD63-23.4	6.4-6.6	6.2-6.39	3.0	14.1-14.35	4850	3000
	26.5	29.5	6.4-12.7 (16.3-32.3)	JX-ACD63-26.5						
	29.7	32.7	9.5-15.9 (24.1-40.3)	JX-ACD63-29.7						
7.7	27.7	30.7	1.0-9.5 (2.5-24.1)	JX-ACD77-27.7	7.9-8.3	7.6-7.79	3.6	15-15.8	6650	4850
	34	37	6.4-15.9 (16.3-40.3)	JX-ACD77-34						

BLIND RIVET SERIES

Large Flange Load Spreading rivets

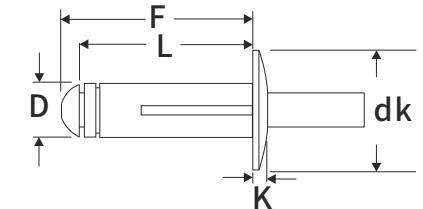

Material:Aluminum Body+Aluminum Mandrel
Domed Head Load Spreading

Unit :Inch/mm

Size	L	F	Grip Range	Part NO	Hole Size	D	K	dk	Shear Strength lbs N	Tensile Strength lbs N
5/32 (4.0)	.690 (17.5)	.800 (20.3)	0-.250 (0-6.4)	JX-ACD508ASMLF12	.197-.205 (5.0-5.21)	.184-.194 (4.7-4.97)	.067-.075 (1.7-1.90)	.460-.482 (11.7-12.5)	135 (600)	225 (1000)
	.787 (19.8)	.890 (22.6)	.118-.375 (3.0-9.5)	JX-ACD512ASMLF12						
	.925 (23.5)	1.040 (26.4)	.197-.469 (5.0-12.0)	JX-ACD516ASMLF12						
3/16 (4.8)	.690 (17.5)	.800 (20.3)	0-.250 (0-6.4)	JX-ACD 608 ASMLF14	.197-.205 (5.0-5.21)	.184-.194 (4.7-4.97)	.067-.075 (1.7-1.90)	.539-.563 (13.7-14.3)	225 (1000)	312 (1400)
	.787 (19.8)	.890 (22.6)	.118-.375 (3.0-9.5)	JX-ACD 612 ASMLF14						
	.925 (23.5)	1.040 (26.4)	.197-.469 (5.0-12.0)	JX-ACD 616 ASMLF14						
	.690 (17.5)	.800 (20.3)	0-.250 (0-6.4)	JX-ACD 608 ASMLF16						
	.787 (19.8)	.890 (22.6)	.118-.375 (3.0-9.5)	JX-ACD 612 ASMLF16						
	.925 (23.5)	1.040 (26.4)	.197-.469 (5.0-12.0)	JX-ACD 616 ASMLF16						

120° Countersunk Head Close End Steel blind rivet

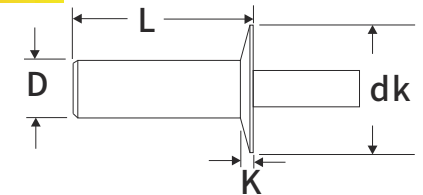

Material:Steel Body+ Steel Mandrel
120° Countersunk Head Close End

Unit :Inch/mm

Size	L	Grip Range	Part NO	Hole Size	D	K	dk	Shear Strength lbs N	Tensile Strength lbs N
1/8 (3.2)	.295 (7.5)	0-.098 (0-2.5)	JX-SK 41 H	.129-.133 (3.28-3.38)	.124-.129 (3.15-3.28)	.03-.04 (0.77-1.02)	.223-.247 (5.68-6.29)	315 (1400)	405 (1800)
	.358 (9.1)	.098-.161 (2.5-4.1)	JX-SK 42 H						
1/8 (3.2)	.422 (10.7)	.161-.220 (4.1-5.6)	JX-SK 43 H	.129-.133 (3.28-3.38)	.124-.129 (3.15-3.28)	.03-.04 (0.77-1.02)	.223-.247 (5.68-6.29)	315 (1400)	405 (1800)
	.484 (12.3)	.220-.283 (5.6-7.2)	JX-SK 44 H						