

BLIND RIVET SERIES

Multi-Grip blind rivet

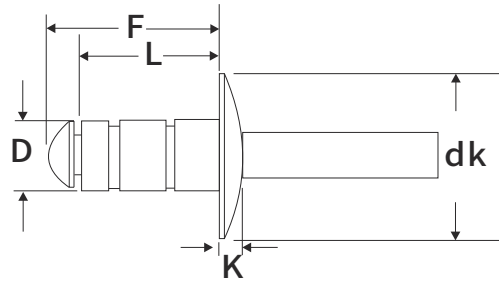

P/N: AD X-X ABS
Material: Aluminum Body+Aluminum Mandrel
Domed Head Multi Grip

P/N: JX-AD X-X SSBS
Material: Aluminum Body+Stainless Steel Mandrel
Domed Head Multi Grip

P/N: JX-AD X-X BS
Material: Aluminum Body+Steel Mandrel
Domed Head Multi Grip

Unit: Inch/mm

Size	L	F	Grip Range	Part NO	Hole Size	D	K	dk	Shear Strength lbs N	Tensile Strength lbs N
1/8 (3.2)	.313 (8.0)	.433 (11.0)	.039-.187 (1.0-4.8)	JX-AD 41-43 ABS JX-AD 41-43 SSBS JX-AD 41-43 BS	.129-.142 (3.28-3.61)	.122-.128 (3.12-3.28)	.032-.040 (0.82-1.02)	.238-.262 (6.04-6.65)	150 (667)	220 (978)
	.453 (11.5)	.573 (14.6)	.157-.312 (4.0-7.9)	JX-AD 43-45 ABS JX-AD 43-45 SSBS JX-AD 43-45 BS						
	.594 (15.1)	.714 (18.1)	.251-.437 (6.4-11.1)	JX-AD 45-47 ABS JX-AD 45-47 SSBS JX-AD 45-47 BS						
5/32 (4.0)	.400 (9.5)	.540 (13.7)	.047-.250 (1.2-6.4)	JX-AD 52-54 ABS JX-AD 52-54 SSBS JX-AD 52-54 BS	.160-.173 (4.06-4.39)	.153-.159 (3.92-4.07)	.039-.047 (1.0-1.2)	.297-.327 (7.54-8.3)	250 (1112)	360 (1601)
	.485 (12.3)	.625 (15.9)	.126-.312 (3.2-7.9)	JX-AD 53-55 ABS JX-AD 53-55 SSBS JX-AD 53-55 BS						
	.715 (18.2)	.855 (21.7)	.251-.500 (6.4-12.7)	JX-AD 56-58 ABS JX-AD 56-58 SSBS JX-AD 56-58 BS						
3/16 (4.8)	.425 (10.8)	.585 (14.9)	.063-.250 (1.6-6.4)	JX-AD 62-64 ABS JX-AD 62-64 SSBS JX-AD 62-64 BS	.192-.205 (4.88-5.21)	.183-.191 (4.68-4.89)	.047-.055 (1.2-1.41)	.360-.390 (9.14-9.91)	350 (1556)	505 (2246)
	.605 (15.4)	.765 (19.4)	.188-.375 (4.8-9.5)	JX-AD 63-66 ABS JX-AD 63-66 SSBS JX-AD 63-66 BS						
	.716 (18.2)	.876 (22.3)	.251-.500 (6.4-12.7)	JX-AD 66-68 ABS JX-AD 66-68 SSBS JX-AD 66-68 BS						
1/4 (6.4)	.105 (26.7)	1.21 (30.7)	.438-.750 (11.1-19.1)	JX-AD 68-612 ABS JX-AD 68-612 SSBS JX-AD 68-612 BS	.257-.275 (6.53-6.99)	.249-.257 (6.37-6.53)	.065-.073 (1.66-1.87)	.475-.525 (12.06-13.34)	460 (2046)	560 (2491)
	.600 (15.2)	.780 (19.80)	.080-.350 (2.0-8.9)	JX-AD 82-86 ABS JX-AD 82-86 SSBS JX-AD 82-86 BS						

BLIND RIVET SERIES

Large Flange Multi Grip blind rivet

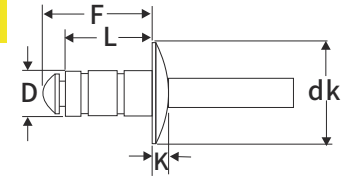

Material: Aluminum Body+Steel Mandrel
Large Flange Multi Grip

Unit: Inch/mm

Size	L	F	Grip Range	Part NO	Hole Size	D	K	dk	Shear Strength lbs N	Tensile Strength lbs N
1/8 (3.2)	.313 (8.0)	.433 (11.0)	.126-.187 (.990-4.8)	JX-AD 41-43 BS LF	.129-.142 (3.3-3.61)	.122-.128 (3.10-3.28)	.036-.052 (0.91-1.33)	.360-.390 (9.14-9.91)	150 (667)	220 (978)
	.453 (11.5)	.573 (14.6)	.157-.312 (4.0-7.9)	JX-AD 43-45 BS LF						
5/32 (4.0)	.400 (10.2)	.540 (13.7)	.047-.250 (1.2-6.4)	JX-AD 52-54 BS LF	.160-.173 (4.06-4.39)	.153-.159 (3.92-4.07)	.055-.071 (1.41-1.82)	.448-.488 (11.47-12.49)	250 (1112)	360 (1601)
	.485 (12.3)	.625 (15.9)	.126-.312 (3.2-7.9)	JX-AD 53-55 BS LF						
3/16 (4.8)	.425 (10.8)	.585 (14.9)	.063-.250 (1.6-6.4)	JX-AD 62-64 BS LF	.192-.205 (4.88-5.21)	.183-.191 (4.68-4.89)	.067-.083 (1.72-2.12)	.600-.650 (15.36-16.64)	350 (1556)	505 (2246)
	.716 (18.2)	.876 (22.3)	.251-.500 (6.4-12.7)	JX-AD 66-68 BS LF						
	1.05 (26.7)	1.21 (30.7)	.438-.750 (11.1-19.1)	JX-AD 68-612 BS LF						

Multi Grip 120° Countersunk head Aluminum blind rivet

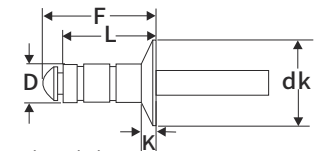

Material: Aluminum Body+Steel Mandrel
120° Countersunk head open end P/N: JX-AK-X-X BS

P/N: JX-AK-X-X SSBS
Material: Aluminum Body+Stainless Steel Mandrel
120° Countersunk head open end

Unit: Inch/mm

Size	L	F	Grip Range	Part NO	Hole Size	D	K	dk	Shear Strength lbs N	Tensile Strength lbs N
1/8 (3.2)	.375 (9.5)	.477 (12.1)	.039-.252 (1.0-6.40)	JX-AK 41-44 BS JX-AK 41-44 SSBS	.129-.142 (3.28-3.67)	.122-.128 (3.12-3.28)	.020-.036 (0.51-0.91)	.207-.233 (5.3-5.97)	150 (667)	220 (978)
3/16 (4.8)	.565 (14.4)	.725 (18.4)	.126-.375 (3.2-9.6)	JX-AK 64-66 BS JX-AK 64-66 SSBS	.192-.196 (4.88-5.21)	.183-.191 (4.68-4.89)	.070-.080 (1.79-2.05)	.333-.363 (8.45-9.22)	350 (1556)	505 (2246)
	.716 (18.2)	.876 (22.3)	.251-.500 (6.4-12.7)	JX-AK 66-68 BS JX-AK 66-68 SSBS						