

JX Fasteners for Metal Sheets and Panels Series

JX-N10 Self-Clinching Receptacle Nuts

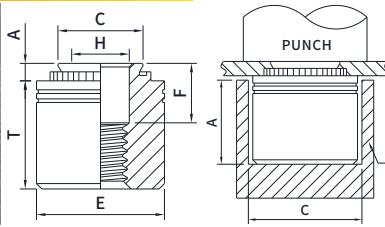

Part Number Designation
 JX-N10 - 832 - 1 - Z1
 Type Thread Shank Finish
 Code Code Code Code

- Material: Carbon Steel
- Material: Stainless Steel

All dimensions are in inches.

UNIFIED	Thread Size	Type	Thread Code	Shank Code	A (Shank) Max.	Min. Sheet Thickness	Hole Size In Sheet +.003 -.000	C Max.	E Nom.	F ± 010	H Nom.	T ± 005	Min. Dist. Hole C/L To Edge
	.112-40 (#4-40)	JX-N10	440	1	.038	.040	.187	.186	.28	.130	.126	.24	.22
.138-32 (#6-32)	JX-N10	632	1	.038	.040	.213	.212	.31	.130	.156	.24	.27	
.164-32 (#8-32)	JX-N10	832	1	.038	.040	.250	.249	.34	.130	.187	.24	.28	
.190-32 (#10-32)	JX-N10	032	1	.038	.040	.277	.276	.37	.130	.213	.24	.31	

All dimensions are in millimeters.

METRIC	Thread Size	Type	Thread Code	Shank Code	A (Shank) Max.	Min. Sheet Thickness	Hole Size In Sheet +0.08	C Max.	E Nom.	F ±0.25	H Nom.	T ±0.13	Min. Dist. Hole C/L To Edge
	M3x0.5	JX-N10	M3	1	0.97	1	4.75	4.73	7.11	3.3	3.2	6	5.59
M4x0.7	JX-N10	M4	1	0.97	1	6.35	6.33	8.64	3.3	4.75	6	7.11	
M5x0.8	JX-N10	M5	1	0.97	1	7.04	7.01	9.53	3.3	5.41	6	7.87	

JX-Pr10 Self-Clinching Flush-Mounted Retainers

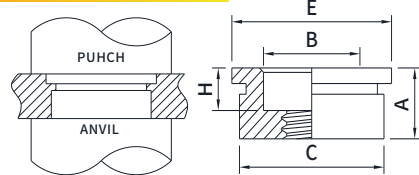

Part Number Designation
 JX-PR10 - 832
 Type Thread
 Code Code

All dimensions are in inches.

UNIFIED	Thread Size	Type	Thread Code	A (Shank) Max.	Min. Sheet for Self-Clinching	Min. Sheet for Flush Installation	Hole Size In Sheet +.003 -.000	B Nom.	C Max.	E Nom.	H Nom.	Min. Dist. Hole C/L To Edge
	.112-40 (#4-40)	JX-PR10	440	1	.125	.050	.125	.281	.195	.280	.31	.075
.138-32 (#6-32)	JX-PR10	632	1	.125	.050	.125	.312	.225	.311	.34	.075	.33
.164-32 (#8-32)	JX-PR10	832	1	.125	.050	.125	.344	.255	.343	.37	.075	.34
.190-32 (#10-32)	JX-PR10	032	1	.125	.050	.125	.375	.290	.374	.41	.075	.36

All dimensions are in millimeters.

METRIC	Thread Size	Type	Thread Code	A (Shank) Max.	Min. Sheet for Self-Clinching	Min. Sheet for Flush Installation	Hole Size In Sheet +0.08	B Nom.	C Max.	E Nom.	H Nom.	Min. Dist. Hole C/L To Edge
	M3x0.5	JX-PR10	M3	1	3.18	1.27	3.18	7.14	4.75	7.12	7.87	1.91
M4x0.7	JX-PR10	M4	1	3.18	1.27	3.18	8.74	6.48	8.72	9.53	1.91	8.64
M5x0.8	JX-PR10	M5	1	3.18	1.27	3.18	9.53	7.37	9.5	10.41	1.91	9.14

Remark: We only show part of the specifications, we can also produce various sizes according to the customer's requirements

JX Fasteners for Metal Sheets and Panels Series

JX-Ps10 Flush-Mounted Screws



Diagonal knurl identifies metric thread sizes.

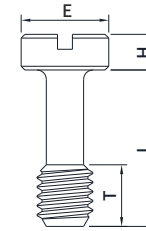
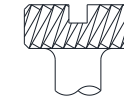

Part Number Designation
 JX-PS10 - 832 - 40
 Type Thread Screw
 Code Code Length
 Code Code Code

All dimensions are in inches.

UNIFIED	Thread Size	Type	Thread Code	Screw Length Code	E Nom.	H +.002 -.006	L ± 010	T Nom.
	.112-40 (#4-40)	JX-PS10	440	40	.18	.075	.33	.13
.138-32 (#6-32)	JX-PS10	632	40	.21	.075	.33	.13	
.164-32 (#8-32)	JX-PS10	832	40	.25	.075	.33	.13	
.190-32 (#10-32)	JX-PS10	032	40	.28	.075	.33	.13	

All dimensions are in millimeters.

METRIC	Thread Size	Type	Thread Code	Screw Length Code	E Nom.	H +0.05 -0.15	L ±0.25	T Nom.
	M3x0.5	JX-PS10	M3	40	4.7	1.91	8.38	3.3
M4x0.7	JX-PS10	M4	40	6.3	1.91	8.38	3.3	
M5x0.8	JX-PS10	M5	40	7.1	1.91	8.38	3.3	

JX-PF10 Flush-Mounted Panel Screw Components

All dimensions are in inches.

UNIFIED	A Min.	B Nom.	G ± 010	M	P	T Nom.
	.04	.125	.40	.16	.28	.13

All dimensions are in millimeters.

METRIC	A Min.	B Nom.	G ±0.25	M	P	T Nom.
	1	3.18	10.16	4.06	7.11	3.3

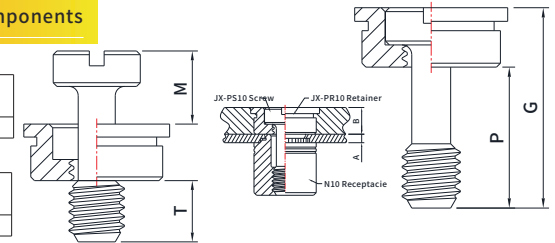

All dimensions are in inches.

UNIFIED	Thread Size	Type	Thread Code	Shank Code	A (Shank) Max.	Min. Sheet Thickness	Hole Size In Sheet +.003 -.000	C Max.	D Max.	E Max.	F ± 010	T ±.010	Min. Dist. Hole C/L To Edge
	.112-40 (#4-40)	JX-F10NS	440	1	.038	.040	.290	.289	.290	.36	.102	.200	.30
.138-32 (#6-32)	JX-F10NS	632	1	.038	.040	.327	.327	.330	.39	.102	.193	.32	
.164-32 (#8-32)	JX-F10NS	832	1	.038	.040	.368	.367	.365	.44	.102	.191	.34	
.190-32 (#10-32)	JX-F10NS	032	1	.038	.040	.406	.405	.405	.47	.102	.250	.36	

All dimensions are in millimeters.

METRIC	Thread Size	Type	Thread Code	Shank Code	A (Shank) Max.	Min. Sheet Thickness	Hole Size In Sheet +0.08	C Max.	D Max.	E Max.	F ±0.25	T ±0.25	Min. Dist. Hole C/L To Edge
	M3x0.5	JX-F10NS	440	1	.038	.040	.290	.289	.290	.36	.102	.200	.30
M4x0.7	JX-F10NS	632	1	.038	.040	.327	.327	.330	.39	.102	.193	.32	
M5x0.8	JX-F10NS	832	1	.038	.040	.368	.367	.365	.44	.102	.191	.34	

Remark: We only show part of the specifications, we can also produce various sizes according to the customer's requirements