

JX Fasteners for Metal Sheets and Panels Series

Locking Thread Nuts

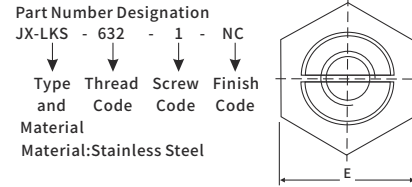
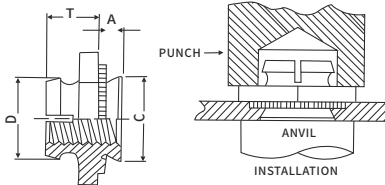

Part Number Designation
 JX-LKS - 632 - 1 - NC
 ↓ ↓ ↓ ↓
 Type Thread Screw Finish
 and Code Code Code Code
 Material:Stainless Steel

Part Number Designation
 JX-LKA - 632 - 1 - A
 ↓ ↓ ↓ ↓
 Type Thread Screw Finish
 and Code Code Code Code
 Material:Aluminum

Part Number Designation
 JX-LK - 632 - 1 - ZB
 ↓ ↓ ↓ ↓
 Type Thread Screw Finish
 and Code Code Code Code
 Material:Carbon Steel

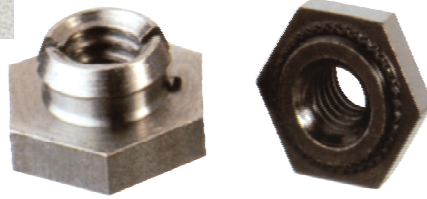

All dimensions are in inches

	Thread Size	Type			Thread Code	Shank Code	A Max.	Min. Sheet Thickness	Hole Size in Sheet +.003	C Max.	D Max.	E Nom.	T ±0.10
		Carbon Steel	Stainless Steel	Aluminum									
UNIFIED	.86-56 (#4-40)	JX-LK	JX-LKS	JX-LKA	256	1	.038	.040	.172	.171	.165	.250	.135
	.112-40 (#6-32)	JX-LK	JX-LKS	JX-LKA	440	1	.038	.040	.187	.186	.185	.250	.135
	.138-32 (#8-32)	JX-LK	JX-LKS	JX-LKA	632	1	.038	.040	.219	.217	.220	.315	.140
.164-32 (#10-32)	JX-LK	JX-LKS	JX-LKA	832	1	.038	.040	.266	.264	.250	.354	.175	
.190-20 (#1/4-20)	JX-LK	JX-LKS	JX-LKA	032	1	.038	.040	.312	.311	.285	.375	.205	

All dimensions are in millimeters

	Thread Size x Pitch	Type			Thread Code	Shank Code	A Max.	Min. Sheet Thickness	Hole Size in Sheet +0.08	C Max.	D Max.	E Nom.	T ±0.25
		Carbon Steel	Stainless Steel	Aluminum									
METRIC	M2.5x0.45	JX-LK	JX-LKS	JX-LKA	M2.5	1	0.97	1	4.4	4.34	4.45	6.35	3.48
	M3x0.5	JX-LK	JX-LKS	JX-LKA	M3	1	0.97	1	4.75	4.72	4.85	6.35	3.48
	M4x0.7	JX-LK	JX-LKS	JX-LKA	M4	1	0.97	1	6.75	6.71	6.2	9.0	4.37
M5x0.8	JX-LK	JX-LKS	JX-LKA	M5	1	0.97	1	7.9	7.88	7.4	9.5	5.13	

Remark: We only show part of the specifications, we can also produce various sizes according to the customer's requirements

JX Fasteners for Metal Sheets and Panels Series

Nylon Insert, Locking Thread Nut

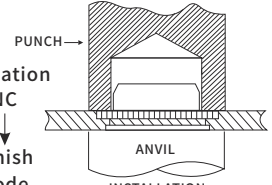

Part Number Designation
 JX-PLS - 440 - NC
 ↓ ↓ ↓
 Type Thread Finish
 and Code Code Code
 Material:Stainless steel

Part Number Designation
 JX-PL - 440 - ZI
 ↓ ↓ ↓
 Type Thread Finish
 and Code Code Code
 Material:Carbon steel

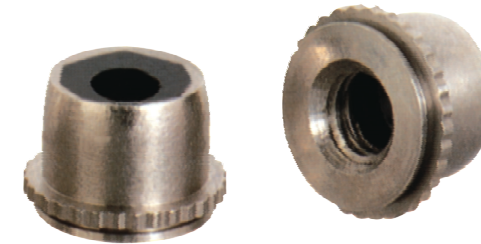
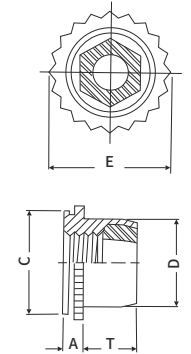

All dimensions are in inches

	Thread Size	Type		Thread Code	A Max.	Sheet Thickness	Hole Size in Sheet +.003	C Max.	D Max.	E Max.	T Max.
		Carbon Steel	Stainless Steel								
UNIFIED	.112-40 (#4-40)	JX-PL	JX-PLS	440	.060	.059-.070	.234	.233	.216	.28	.130
	.138-32 (#6-32)	JX-PL	JX-PLS	632	.060	.059-.070	.265	.264	.246	.31	.130
	.164-32 (#8-32)	JX-PL	JX-PLS	832	.060	.059-.070	.297	.296	.278	.34	.155
.190-32 (#10-32)	JX-PL	JX-PLS	032	.060	.059-.070	.312	.311	.292	.35	.165	

All dimensions are in millimeters

	Thread Size x Pitch	Type		Thread Code	A Max.	Sheet Thickness	Hole Size in Sheet +0.08	C Max.	D Max.	E Max.	T Max.
		Steel	Stainless Steel								
METRIC	M3x0.5	JX-PL	JX-PLS	M3	1.5	1.5-1.78	6	5.97	5.5	7.1	3.6
	M4x0.7	JX-PL	JX-PLS	M4	1.5	1.5-1.78	7.5	7.47	7	8.6	4.2
	M5x0.8	JX-PL	JX-PLS	M5	1.5	1.5-1.78	8	7.97	7.5	8.9	4.5

Remark: We only show part of the specifications, we can also produce various sizes according to the customer's requirements