

JX BLIND RIVET NUTS FASTENERS SERIES

Stainless Steel Flat Head Open End Round Body blind rivet nuts

Material:Stainless Steel

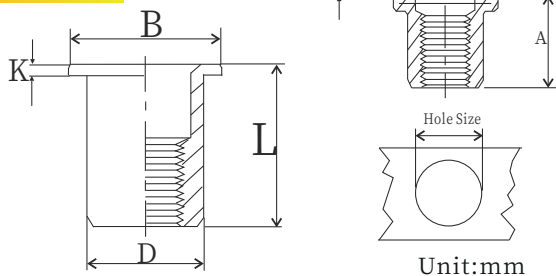

Unit:mm

Size	Part No	Grip Range T	A Ref	Hole Size $\begin{smallmatrix} +0.1 \\ 0 \end{smallmatrix}$	D $\begin{smallmatrix} +0.07 \\ -0.1 \end{smallmatrix}$	B	K ± 0.2	L $\begin{smallmatrix} +0.15 \end{smallmatrix}$
M4	JX-FS-M4-10.5	0.5-2.0	6.0	6.0	5.9	8.5	0.8	10.5
	JX-FS-M4-10.8	1.75-2.5	6.5	6.0	5.9	8.5	1.0	10.8
	JX-FS-M4-11.6	2.5-3.25	6.5	6.0	5.9	8.5	1.0	11.6
M5	JX-FS-M5-13	0.5-2.5	7.5	7.0	6.9	10.0	1.0	13.0
	JX-FS-M5-13.7	2.0-3.0	8.7	7.0	6.9	9.0	1.0	13.7
	JX-FS-M5-14.8	3.0-4.0	8.7	7.0	6.9	9.0	1.0	14.8
M6	JX-FS-M6-15.5	0.5-3.0	9.2	9.0	8.9	12.3	1.3	15.5
	JX-FS-M6-16.6	1.5-3.0	11	9.0	8.9	11	1.5	16.6
	JX-FS-M6-18.2	3.0-4.5	11	9.0	8.9	11	1.5	18.2
M8	JX-FS-M8-18.5	1.0-3.5	11.5	11.0	10.9	15.0	1.5	18.5
	JX-FS-M8-19.6	3.0-4.5	12	11	10.9	14.0	1.5	19.6
M10	JX-FS-M10-21	1.0-4.0	12.5	13.0	12.9	17.0	1.6	21.0
	JX-FS-M10-24	3.0-4.5	16	13.0	12.9	16.0	2.0	24
	JX-FS-M10-25.6	4.5-6.0	16	13.0	12.9	16.0	2.0	25.6

Stainless Steel Flat Head Close End Round Body blind rivet nuts

Integrated sealing function,Stable tensile strength in this mating screw

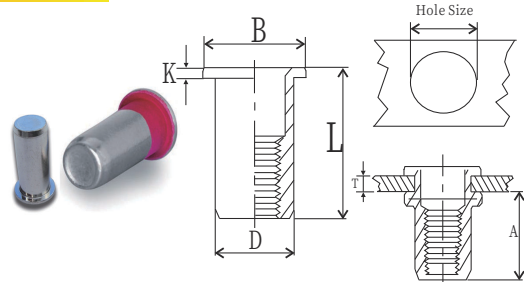

Material:Stainless Steel

Unit:mm

Thread Size	P/N	Grip Range T	A Ref	Hole Size $\begin{smallmatrix} +0.1 \\ 0 \end{smallmatrix}$	D $\begin{smallmatrix} +0.07 \\ -0.1 \end{smallmatrix}$	B ± 0.20	K ± 0.2	L $\begin{smallmatrix} +0.3 \end{smallmatrix}$
M4	JX-BFS-M4-16	0.5-2.0	11.3	6.0	5.9	9.0	0.8	16
M5	JX-BFS-M5-19	0.5-2.5	13.8	7.0	6.9	10.0	1.0	19
M6	JX-BFS-M6-21	0.5-3.0	15.0	9.0	8.9	12.3	1.3	21
M8	JX-BFS-M8-25	1.0-3.5	18.2	11.0	10.9	15.5	1.5	25
M10	JX-BFS-M10-27	1.0-4.0	19.4	13.0	12.9	17.0	1.6	27

JX BLIND RIVET NUTS FASTENERS SERIES

Falt Head Open end Knurled Body Blind Rivet Nuts

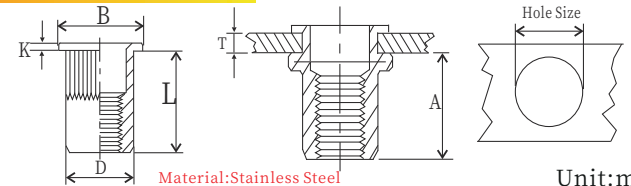

Material:Stainless Steel

Unit:mm

Size	Part No	Grip Range T	A Max	Hole Size $\begin{smallmatrix} +0.1 \\ -0 \end{smallmatrix}$	D $\begin{smallmatrix} +0.07 \\ -0.1 \end{smallmatrix}$	B ± 0.2	K ± 0.2	L $\begin{smallmatrix} +0.2 \end{smallmatrix}$
M3	JX-FS-M3-R-9.3	0.7-1.5	5.9	5	4.9	7	1.0	9.3
	JX-FS-M3-R-10.4	1.5-2.5	5.9	5	4.9	7	1.0	10.4
M4	JX-FS-M4-R-10.5	0.5-2.0	6.5	6	5.9	9.0	0.8	10.5
	JX-FS-M4-R-10.6	1.5-2.5	6	6	5.9	8.0	1.0	10.6
	JX-FS-M4-R-11.7	2.5-3.5	6	6	5.9	8.0	1.0	11.7
M5	JX-FS-M5-R-13	0.5-2.5	8.0	7.0	6.9	10.0	1.0	13
	JX-FS-M5-R-13.3	1.5-3.0	7.8	7.0	6.9	9.0	1.0	13.3
	JX-FS-M5-R-14.4	3.0-4.0	7.8	7.0	6.9	9.0	1.0	14.4
M6	JX-FS-M6-R-15.5	0.5-3.0	9.2	9.0	8.9	12.3	1.3	15.5
	JX-FS-M6-R-16.4	3.0-4.5	8.6	9.0	8.9	11	1.5	16.4
	JX-FS-M6-R-18.2	4.5-6.0	8.6	9.0	8.9	11	1.5	18.2
M8	JX-FS-M8-R-15.3	0.8-1.5	10.6	11	10.9	14	1.5	15.3
	JX-FS-M8-R-18.5	1.0-3.5	11.5	11	10.9	14.5	1.5	18.5
	JX-FS-M8-R-18.4	3.0-4.5	10.6	11	10.9	14	1.5	18.4
	JX-FS-M8-R-20	4.5-6.0	10.6	11	10.9	14	1.5	20
M10	JX-FS-M10-R-19.8	0.8-1.5	13.9	13	12.9	16	2.0	19.8
	JX-FS-M10-R-21	1.0-4.0	13.5	13	12.9	17	1.6	21
	JX-FS-M10-R-23	3.0-4.5	13.9	13	12.9	16	2.0	23
	JX-FS-M10-R-24.6	4.5-6.0	13.9	13	12.9	16	2.0	24.6
M12	JX-FS-M12-R-23	0.8-1.5	17.2	16	15.9	20	2.0	23
	JX-FS-M12-R-24.6	1.5-3.0	17.2	16	15.9	20	2.0	24.6
	JX-FS-M12-R-26.2	3.0-4.5	17.2	16	15.9	20	2.0	26.2
	JX-FS-M12-R-27.8	4.5-6.0	17.2	16	15.9	20	2.0	27.8

Falt Head Open end Knurled Body Blind rivet nuts

Material:Stainless Steel

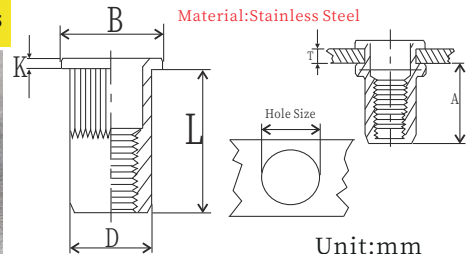

Unit:mm

Thread Size	Part No	Grip Range T	A Ref	Hole Size $\begin{smallmatrix} +0.1 \\ 0 \end{smallmatrix}$	D $\begin{smallmatrix} +0.07 \\ -0.1 \end{smallmatrix}$	B ± 0.2	K ± 0.1	L $\begin{smallmatrix} +0.2 \end{smallmatrix}$
M4	JX-BFS-M4-R-16	0.5-2.0	11.8	6.0	5.9	9.0	0.8	16
M5	JX-BFS-M5-R-17	0.5-2.5	12.0	7.0	6.9	10	1.0	17
M6	JX-BFS-M6-R-19.2	0.5-3.0	12.7	9.0	8.9	12.3	1.3	19.2
M6	JX-BF2.5S-M6-R-19.0	0.5-2.5	11.5	9.0	8.9	15.0	2.5	19.0
M8	JX-BFS-M8-R-21.5	1.0-3.5	14.2	11.0	10.9	15.0	1.5	21.5
M10	JX-BFS-M10-R-27	1.0-4.0	18.0	13.0	12.9	17.0	1.6	27